

In CHANCERY.—Between HARRINGTON OFFLEY SHORE, an Infant, by SAMUEL BREWIN, his next friend, Plaintiff;
OFFLEY SHORE and OTHERS, Defendants.

PARTICULARS & CONDITIONS OF SALE

OF THE

FREEHOLD ESTATES

AND OTHER PROPERTY,

OF SAMUEL SHORE, ESQ. OF NORTON HALL, IN THE COUNTY OF DERBY, DECEASED,

SITUATE IN

The PARISH of NORTON and the TOWNSHIP of COAL ASTON,
IN THE PARISH OF DRONFIELD, IN THE COUNTY OF DERBY;

The TOWNSHIPS of DORE and TOTLEY,
IN THE SAID PARISH OF DRONFIELD;

And the PARISH of SHEFFIELD,
IN THE COUNTY OF YORK; COMPRISING

NORTON HALL,

AND ITS

PARK AND WOODLANDS;

THE MANOR AND LAY RECTORY OF NORTON,

SEVERAL VILLA RESIDENCES, MILLS, WORKS, SHOOTING LODGE,
AND UPWARDS OF

2100 ACRES

Of ARABLE, PASTURE, BUILDING, WOOD, & MOORLAND,

WHICH

WILL BE SOLD,

PURSUANT TO AN ORDER OF THE HIGH COURT OF CHANCERY BEARING DATE THE 5th DAY OF MARCH 1847, WITH THE APPROBATION OF
THE HONOURABLE SIR GEORGE ROSE, ONE OF THE MASTERS OF THE SAID COURT.

AT THE COUNCIL HALL, IN SHEFFIELD AFORESAID,

ON TUESDAY, THE 2ND DAY OF JULY, 1850,

AND THE FOUR FOLLOWING DAYS.

THE SALE TO COMMENCE ON EACH DAY AT TWO O'CLOCK PRECISELY. (IN LOTS.)

BY MR. JOSEPH NICHOLSON,

THE PERSON APPOINTED BY THE SAID MASTER FOR THAT PURPOSE.

PLANS of the ESTATES, and PARTICULARS, may be had gratis, in London, at the said Master's Chambers, in Southampton Buildings, Chancery Lane, on personal application only; also of Mr. TATTERSHALL, Solicitor, 9, Great James's street, Bedford row; of Messrs. CHURCH and LANGDALE, Solicitors, 38, Southampton Buildings; and in the County of Messrs. ALBERT SMITH and SON and Messrs. BRAMLEY and GAINSFORD, Solicitors, Sheffield; of Messrs. FOWLER and SON, Land Agents, Bank street, Sheffield; of the said Mr. JOSEPH NICHOLSON, Auctioneer, High street, Sheffield; of Mr. WRIGHT, of Jordanthorpe, Norton near Sheffield; and at any of the principal Inns in Sheffield, Leeds, Manchester, Liverpool, Rotherham, Doncaster, Chesterfield, Derby, and Birmingham.

Mr. WRIGHT, of Jordanthorpe, will shew all such parts of Estate as consist of Land, Norton Hall, and any of the Houses which are not let, at any time until the Sale; and the interior of any of the Houses which are in the occupation of Tenants may be viewed, with their permission, during the first week in the month of June, on application to Mr. Wright.

PRINTED BY ROBERT LEADER, INDEPENDENT OFFICE, BANK-STREET, SHEFFIELD.

In CHANCERY.—SHORE v. SHORE.

PLANS, PARTICULARS, AND CONDITIONS

OF SALE OF THE

FREEHOLD ESTATES

And other PROPERTY,

OF SAMUEL SHORE, ESQ. DECEASED,

IN THE PARISH OF NORTON AND THE TOWNSHIP OF
COAL ASTON,

In the Parish of Dronfield, in the County of Derby;

IN THE TOWNSHIPS OF TOTLEY AND DORE,

In the same Parish of Dronfield;

AND IN THE PARISH OF SHEFFIELD,

In the County of York; comprising

NORTON HALL,

WITH ITS

PARK AND WOODLANDS;

THE MANOR AND LAY RECTORY OF NORTON,

SEVERAL VILLA RESIDENCES, MILLS, WORKS,
SHOOTING LODGE,

AND

UPWARDS OF 2100 ACRES

Of Arable, Pasture, Building, Wood, & Moorland,

WHICH

WILL BE SOLD,

PURSUANT TO AN ORDER OF THE HIGH COURT OF CHANCERY, WITH THE APPROBATION OF THE HON. SIR GEORGE ROSE, ONE OF THE MASTERS OF THE SAID COURT.

AT THE COUNCIL HALL, IN SHEFFIELD,

ON TUESDAY, THE 2ND DAY OF JULY, 1850,

AND THE FOUR FOLLOWING DAYS.

The Sale to commence on each Day at Two o'clock precisely.

ALBERT SMITH & SON, Sheffield;

E. B. TATTERSHALL, 9, Great James street,
Bedford Row.



Thos. G. S. J. in the Queen

N O R T O N H A L L .

*Fowler & Son
Sheffield*



HOUSE AT NORTON LEES

IN LOT LXVIII, MAP NO. 1.



Day & Son Lith'rs the Queen

HOUSE AT NORTON LEES

IN LOT LXXXI. MAP N^o 1.

*Foster & Son
Sheffield*



WEST VIEW .

IN LOT LXXXV MAP N^O. 1.



Day & Son, Lith^{rs} to the Queen

CLIFFE FIELD.

IN LOT LXXIX MAP N^o 1.

*Forster & Son
Sheffield*

PARTICULARS.

IN THE COUNTY OF DERBY.

ESTATE

IN THE PARISH OF NORTON,

AND THE TOWNSHIP OF COAL ASTON IN THE PARISH OF DRONFIELD.

ON TUESDAY the 2nd day of JULY 1850, the following Lots Numbered from 1 to 94, both inclusive, (the Land comprised in which is shewn in Map I annexed to these Particulars,) will be offered for Sale in one Lot, and if not Sold in that manner, will on that and the two succeeding days, be put up for Sale in the following 94 Lots; those Lots which are Numbered from 1 to 24 both inclusive being put up on the said 2nd day of July 1850; those Numbered from 25 to 59 both inclusive on WEDNESDAY the 3rd day of July 1850; and those Numbered from 60 to 94 both inclusive on THURSDAY the 4th day of July 1850.

TENANT'S NAME.	NO. ON PLAN.	DESCRIPTION.	QUANTITY.	TOTALS.
			A. R. P.	A. R. P.
IN THE PARISH OF NORTON.				
LOT 1.				
In hand	527	NORTON HALL, comprising, on the Ground Floor, a handsome Entrance supported by four columns, spacious Entrance Hall, 21 feet by 23 feet; Drawing Room, 33 feet by 21 feet; Dining Room, 32 feet by 21; Library, 21 feet by 22 feet 6 inches; Water Closet, Butler's Pantry, Store Room, Housekeeper's Room, Servants' Hall, large Kitchens supplied with hard and soft Water; Larders, Scullery, and other convenient Offices; with three spacious Cellars, two Wine Cellars, Wash House, and Dairy below. On the First Floor, seven Bed Rooms, with three Dressing Rooms and Water Closet. On the Second Floor, two Bed Rooms, with Dressing Rooms and four other Bed Rooms, Water Closet, Washing Room, Closet for Coal, and other Conveniences, together with numerous Servants' Bed Rooms; with all Out-offices required for the comfortable occupation of the Mansion	1 0 12	
In hand	525	The Stables and adjacent Offices are built in the form of a Square, entering under an Archway, comprising, on the Left Wing, lofty Stables, with five Standings and two loose Boxes; Harness and Corn Rooms; on the Right Wing, six Stalls and Saddle Room; also, in the remainder of the Square, spacious Carriage Houses, warmed with Hot Water Pipes; Granary, numerous loose Boxes and Stalls, Barn, Cowhouses, Sheds; also, two Cottage Houses, for Bailiffs or Servants, Cart Sheds, and Smith and Carpenter's Shops	0 1 18	

TENANT'S NAME	NO. ON PLAN	DESCRIPTION	QUANTITY		TOTALS
			A. R. F.	A. R. F.	
		Brought forward			
LOT 1.—CONTINUED.					
Henry Revell	523	Chapel and Paddock	0 1 37		
In hand	507	Lower Pond	2 2 29		
Do.	508	Middle Pond	0 3 28		
Do.	509	Upper Pond	0 2 36		
Do.	522	Plantation	0 1 25		
Do.	522a	Footway from Bolehill	0 2 21		
Henry Revell	524	Fold, Yard, and Buildings	0 1 29		
John Smith	497	South West Field	4 0 23		
Do.	498	Plantation Close	4 2 0		
In hand	439	Plantation	0 2 14		
John Smith	440	Five Acres	5 1 16		
Do.	441	Footpath Field	4 2 2		
Do.	442	Nursery Croft	2 0 28		
Do.	443	Nursery	2 1 36		
Do.	444	Orchard	1 1 19		
William Docker	445	Garden	0 0 15		
Mary Fisher	446	Garden	0 0 4		
William Shaw	447	Garden	0 0 11		
Francis Shaw	448	Garden	0 0 11		
Edward Boney	449	Garden	0 0 23		
Do.	450	Dwelling-House, Outbuildings, and Garden	0 1 12		
John Smith	451	Do. do. and Stackyard	0 2 38		
Do.	452	Homestead Croft	0 0 23		
Do.	453	Reed	0 1 10		
Do.	454	Croft	1 0 20		
Benjamin Cavill	455	Croft	0 2 12		
Do.	456	Garden	0 0 22		
Do.	457	Croft	0 2 20		
Do.	458	Dwelling-House, Shop, Outbuildings, and Garden	0 0 34		
Thomas Biggin	459	House and Garden	0 2 28		
Do.	460	Stackyard	0 1 29		
In hand	461	Plantation	0 1 0		
Do.	462	Plantation	0 3 39		
Edward Dawson	463	Lodge	0 0 12		
Thomas Biggin	464	North Croft	18 0 28		
John Cam	465	Cobnar and Quarry	2 0 0		
James Veal	466	Far Meadow	2 0 0		
Do.	467	Near Meadow	1 2 11		
Mrs. Seiden	468	Little Meadow	1 1 36		
Do.	469	Gate Field	1 2 32		
James Biggin	470	Little Croft	0 2 4		
Mrs. Seiden	471	Little Field	1 0 32		
James Veal	472	Nether Lyr Lands	1 3 16		
Do.	473	Upper Lyr Lands	2 0 34		

TENANT'S NAME	NO. ON PLAN	DESCRIPTION	QUANTITY		TOTALS
			A. R. F.	A. R. F.	
		Brought forward			
LOT 1.—CONTINUED.					
Joseph Bingham	474	Nether Lyr Lands	2 0 20		
Do.	475	Lyr Lands	2 2 12		
Do.	476	Upper Lyr Lands	0 1 22		
In hand	477	Lyr Land Wood and Cobnar Bank	31 2 12		
Do.	478	Cobnar Bank Top	1 1 17		
Thomas Linsley	479	Far Cobnar	6 1 32		
Do.	480	Middle Cobnar	6 0 34		
Do.	481	Near Cobnar	6 3 24		
Do.	482	Triangular Field	3 2 4		
Do.	484	Wood Field	2 2 18		
Do.	485	Bole Hill Meadow	5 1 4		
Phoebe Cavill	486	Croft	0 2 18		
Do.	487	House, Shop, and Garden	0 0 7		
Joseph Marsden	488	House, Shop, and Garden	0 0 23		
Robert Linsley	489	Workshop and Yard	0 0 10		
Do.	490	Garden	0 0 19		
Phoebe Cavill	491	Garden	0 0 21		
Joseph Marsden	492	Garden	0 0 17		
Thomas Turner	493	Garden	0 0 17		
Henry Revell	494	Garden	0 0 20		
In hand	495	Plantation	0 0 11		
Thomas Linsley	496	Road	0 0 35		
In hand	497	Plantation	0 0 15		
George Oates	498	Garden	0 0 20		
George Shelton	499	Garden	0 0 20		
Ezekiel Snape	500	Garden	0 0 20		
John Shelton	501	Garden	0 0 20		
Thomas Linsley	502	Old Park	12 2 12		
Do.	503	Spring Park	11 3 7		
In hand	504	Park Wood	20 2 8		
John Biggin	505	Summer House and Garden	0 0 39		
Henry Revell	506	Deer Park	24 2 19		
Do.	526	Paddock and Plantation	8 0 17		
James Bingham	528	Park	47 3 31		
Do.	529	Kitchen Garden and Vinery	1 2 9		
Arthur Linsley	530	House and Garden	0 0 18		
Do.	532	Garden	0 0 21		
William Woodcroft	531	House and Garden	0 0 4		
Edward Butler	533	House and Garden	0 0 13		
John Wilderford	534	House and Garden	0 1 0		
Elizabeth Kay	535	House and Garden	0 0 4		
Ann Warhurst	536	House and Garden	0 0 8		
In hand	537	Plantations and Pleasure Grounds	9 0 13		
John Birdes	538	Croft	0 2 2		
Do.	539	Garden	0 1 2		
Thomas Cavill	540	Two Houses, Shop, and Garden	0 0 14		
John Birdes	541	Dwelling-House, Outbuildings, and Garden	0 0 36		

TENANT'S NAME	NO. ON PLAN	DESCRIPTION	QUANTITY	TOTALS
			A. R. P.	A. R. P.
		Brought forward		
		LOT 1.—CONTINUED.		
John Birtles	543	Stack Yard	0 0 32	
Francis Shaw and Francis Shaw, jun.	543	Two Houses, Shop, and Garden	0 0 12	
Francis Shaw	544	Garden	0 0 4	
Mary Fisher and Wm. Booker	545	Two Houses	0 0 4	
Wm. Shaw and others	546	Three Houses	0 0 9	
Thomas Cavill and Robert Hardwick	547	House, Shop, and Yard	0 0 10	
John Birtles	548	Garden	0 0 8	
Thomas Biggin	549	Clay Lands	4 0 30	
Edward Binney	550	Clay Lands	3 0 13	
Do.	551	Meadow	5 1 4	
Thomas Birtles	551a	Meadow	1 3 7	
In hand	552	Plantation	1 1 24	
Thomas Biggin	553	Clay Lands	2 1 25	
Do.	554	Clay Lands	2 3 15	
Do.	555	Clay Lands	3 2 28	
Do.	556	Mouse Park	0 3 20	
Do.	557	Clay Lands	3 1 2	
Do.	558	Clay Lands	3 0 24	
Do.	560	Great Cad Croft	5 2 22	
In hand	561	Serpentine Plantation	1 0 26	
William Wright	562	Norton Lane Field	4 3 20	
Joseph Bunting	563	Cad Croft	4 3 20	
			330. 3. 37	
The Manor or Lordship, or reputed Manor or Lordship, of Norton, in the County of Derby, with the rights, royalties, members, and appurtenances thereto belonging, except all such Minerals as were reserved to the Lord thereof upon the Inclosure of the Commons and Waste Lands therein.				
The Rectory of Norton, (save and except the Perpetual Advowson, Donation, Right of Patronage, and Presentation of or to the Vicarage of Norton-aforesaid,) with the Chancel of Norton Parish Church, or such part thereof as belonged to the said Samuel Shore, with the Rent Charge of £14 per annum, at which the Rectorial Tithes, payable to Mr. Shore, in the Parish of Norton, have been commuted under the Tithe Commutation Acts, which is apportioned upon the Lands in the Parish of Norton, and in the Sums following:—				
OWNER OF LAND.	OCCUPIER OF LAND.	SITUATION OF LAND.	AMOUNT OF ANNUAL RENT CHARGE.	
John Waterfall	Thomas Biggin	Bradway Bank	£ 1 7	
B. B. P. Burnell	Samuel Gillatt	Woodseats	8 18 10	
Rev. J. Boyer	Henry Horridge	Greenhill	2 8 10	
B. B. P. Burnell		Greenhill	0 2 6	
B. B. P. Burnell	Mary Hall	Bradway	0 4 11	
Samuel Bower	Himself	Lowedges	0 7 8	
Rev. John Boyer	George Vardy	Greenhill	1 5 6	
Do.	Butterell	Greenhill	0 6 2	
Richard Sellers	Thomas Wilson	Greenhill	0 4 0	
			£ 14 0 0	
		Carried forward		330. 3. 37

TENANT'S NAME	NO. ON PLAN	DESCRIPTION	QUANTITY	TOTALS
			A. R. P.	A. R. P.
		Brought forward		330. 3. 37
		LOT 2.		
William Gascoigne	521	Mansion House, comprising Dining, Drawing, and Breakfast Rooms; Library, spacious Kitchens, Cellars, and eight good Lodging Rooms; with Carriage House, Stables, Out-offices, and Garden	0 1 32	0. 1. 32
		LOT 3.		
Nutty Moorwood and Mrs. Warhurst	564	Two Gardens	0 0 9	
Thomas Revell	565	Garden	0 0 7	
Joseph Martin	566	Garden	0 0 9	
Jonathan Higginbottom	567	Garden	0 0 8	
John Cocker	568	Garden	0 0 8	
Reuben Rodgers	569	Garden	0 0 8	
Samuel Wood	570	Garden	0 0 3	
Thomas Doddridge	571	Garden	0 0 9	
Daniel Groatorex	572	Garden	0 0 6	
Thomas Butler	573	Garden	0 0 13	
Do.	574	Dwelling-House	0 0 1	
Thomas Doddridge	575	Dwelling-House, Outbuildings, and Garden	0 0 4	
Daniel Groatorex	576	Dwelling-House, Outbuildings, and Garden	0 0 5	
Joseph Martin	577	Dwelling-House	0 0 1	
Reuben Rodgers	578	Dwelling-House	0 0 3	
Samuel Wood	579	Dwelling-House	0 0 3	
	579a	Road and Well. The Public have a right of passing over this Road, and of using the Water in the Well	0 0 10	0. 2. 27
		LOT 4.		
Thomas Revell	580	Dwelling-House and Garden	0 0 5	
John Cocker	581	Dwelling-House and Garden	0 0 6	
James Jenkin	582	Dwelling-House, Outbuildings, Yard, and Garden	0 0 26	
John Higginbottom	582a	Do. and Garden	0 0 1	
Nutty Moorwood	582b	Dwelling-House	0 0 6	
Various Tenants	582c	Road and Outbuildings	0 0 5	
Joseph Bunting	583	Common Piece	0 2 34	
Do.	589	Croft	0 2 28	1. 2. 31
		LOT 5.		
Joseph Bunting	584	Maugherhay Green	1 0 32	
Do.	585	Bowling Green	0 2 6	
Do.	586	Dwelling-House, Yard, Outbuildings, and Garden	0 1 11	
Do.	587	Croft	0 2 11	
Do.	588	Garden	0 0 17	
Do.	588a	Part of Croft	0 0 35	2. 3. 32
		LOT 6.		
Elizabeth Bingham	701	Part of Wood Field	1 3 23	
In hand	703	Swine Ley Wood and Carr Wood	23 1 15	
William Fox	706	Owler Lightwood	5 3 23	
Do.	707	Great Lightwood	10 2 4	
Do.	708	Square Lightwood	3 0 23	
Do.	709	Great Adam Lands	6 3 16	
		Carried forward		336. 2. 39

TENANT'S NAME	NO. ON PLAN	DESCRIPTION	QUANTITY	TOTALS
		Brought forward	A. R. P.	A. R. P.
				336. 2.39
LOT 6.—CONTINUED.				
William Fox	710	Little Adam Lands	4 0 16	
Do.	711	Wood Field	7 2 36	
Do.	712	Cow Meadow	5 1 4	
Do.	713	High Field	6 2 37	
Do.	714	New Dyke	7 0 12	
Do.	714a	Lane	0 1 8	
Do.	715	Yew Tree Croft	2 1 16	
Do.	716	Garden	0 0 35	
Do.	717	House and Garden	0 1 4	85. 2.32
LOT 7.				
William Fox	718	Meadow	4 2 37	
Do.	719	Smogill Croft	1 2 31	6. 1.28
LOT 8.				
James Bingham	590	Carr	2 1 28	
Do.	591	Croft	4 3 28	
Do.	592	Croft	1 0 13	
Do.	593	Malthouse and Garden	0 1 4	
Do.	594	Outbuildings and Yard	0 1 20	
Do.	595	House and Garden	0 1 16	
Do.	596	Wainwright Croft	1 1 2	
Do.	599	Hodge Knowle	3 3 10	
Do.	600	Lower Croft	4 3 1	
Do.	601	Nooks	4 1 29	
Do.	602	Road	0 1 29	
Do.	603	Upper Riddings	5 1 4	
Do.	604	Lower Riddings	4 1 5	
Do.	605	Corner Grave	5 3 5	
Do.	606	Thistley Riddings	4 2 34	
Do.	607	Brierley Furong	7 1 18	
In hand	608	Plantation	0 0 19	
Do.	613	Wood and Quarry	4 1 37	
James Bingham	614	Cockshuts	6 0 7	
Joseph Green	615	Quarry Field	5 3 7	67. 3.36
LOT 9.				
William Wright	620	Part of Wainwright Croft	1 2 22	
Do.	621	Pond	0 1 6	
In hand	622	Plantation	0 3 8	
John Wrecks and William Wright	623 & 624	Mansion House comprising Dining, Drawing, and Breakfast Rooms; Library, Kitchens, Cellars, and seven Lodging Rooms; with Carriage House, Stables, other Outbuildings, and Gardens	1 1 39	
Do.	625	Pond	0 2 0	
Joseph Green	625a	Part of Hall Croft	0 1 30	
Do.	626	Hall Croft	2 3 16	
Do.	626a	Part of Ox Pasture	3 0 3	
Do.	628	Little Hall Field	3 2 2	
Do.	629	Flood Field	4 3 21	
Do.	630	Hall Field	5 3 8	25. 0.35
Carried forward				522. 0.10

TENANT'S NAME	NO. ON PLAN	DESCRIPTION	QUANTITY	TOTALS
		Brought forward	A. R. P.	A. R. P.
				522. 0.10
LOT 10.				
In hand	609	Plantation	0 1 4	
Joseph Green	610	Far Marsh	6 1 30	
Do.	611	Holt	0 0 28	
Do.	612	Near Marsh	5 3 24	
Do.	616	Broom Field	4 1 28	
Do.	617	Little Croft	2 0 7	
Do.	597	House and Garden	0 1 6	
Do.	618	Stack Yard	0 1 14	
Do.	619	Outbuildings and Yard	0 1 24	
Do.	617a	Garden	0 0 21	
Do.	620a	Part of Wainwright Croft and Plantation	0 3 34	
Do.	627	Ox Pasture	6 3 29	
Do.	627a	Part of Hall Croft	1 0 4	
Do.	631	Road	0 0 13	
Samuel Bower	632	Great Hall Field	9 0 16	
Joseph Green	634	Hall Field	8 3 33	
Do.	635	Great Covert	8 1 36	
Do.	636	Range	4 3 32	
Do.	637	Little Covert	4 2 0	
Do.	638	Saw Pit Field	3 1 36	
Do.	639	Great Spring Field	11 0 6	
In hand	640	Coalpit Wood	9 1 4	
Joseph Green	641	Wood Field	8 1 5	
Do.	642	Little Spring Field	9 0 32	
Do.	643	Great White Field	12 0 12	
Do.	644	Little White Field	8 3 32	
Samuel Bower	645	Cocker Field	8 3 32	
Do.	646	Six Acres	6 0 32	
Joseph Green	647	Four Acres	4 2 28	
Do.	648	Near Four Acres	4 3 0	
Samuel Bower	649	Four Acres	4 2 0	156. 3. 2
IN THE TOWNSHIP OF COAL ASTON.				
LOT 11.				
William Mason	3	Broom Hill	1 1 30	
Do.	4	Broom Hill	5 1 24	
Do.	5	Close under Hill	4 3 26	
Do.	6	New Close	2 0 3	
Do.	7	New Close	2 3 10	
John Vickers	8	Man Flatt	2 2 28	
Do.	9	Little Man Flatt	0 3 14	
Do.	10	Bilham Field	1 3 13	
Do.	11	Bilham Field	1 2 0	
Francis Oldhall	12	Close under Hill	3 0 0	
John Vickers	13	Shrog	1 1 24	
Do.	14	Mag Flatt	2 1 0	
Do.	15	Little Field	1 0 28	31. 1. 0
Carried forward				710. 0.12

TENANT'S NAME	NO. ON PLAN	DESCRIPTION	QUANTITY	TOTALS
		Brought forward	A. R. P.	A. R. P.
		LOT 12.		710. 0. 12
In hand	16	Shrog Wood	1 1 6	
Samuel Cooper	17	Old Earth	3 2 16	
George Cowley	18	Old Earth	2 2 32	
William Vickers	19	Old Earth	3 1 19	
Samuel Cooper	20	Old Earth	2 3 36	
Francis Oldall	21	Old Earth	5 1 29	19. 1. 18
		LOT 13.		
William Vickers	25	Henpeper	1 1 32	
Samuel Cooper	27	North Wood Close	4 1 24	5. 3. 16
		LOT 14.		
Francis Oldall	22	Nooks	4 3 4	
In hand	23	Nooks Wood	1 1 32	
Francis Oldall	24	Nooks	3 3 28	10. 0. 24
		LOT 15.		
Charles Jones	85	Colley Field	6 3 8	
Do.	86	Bottom Field	3 1 24	
In hand	87	Colley Field Wood	0 2 32	10. 3. 24
		LOT 16.		
Samuel Meller	84	Bank	4 0 20	4. 0. 20
		LOT 17.		
In hand	82	Plantation and Wood	1 2 1	
George Cowley	83	Bull Piece	4 1 12	5. 3. 13
		LOT 18.		
In hand	79	Bentley Head Plantation	5 2 8	
Thomas Bentley	79a	Common Piece	1 0 12	
Do.	80	Common Piece	1 1 8	
Francis Oldall	81	Bentley Head	5 0 4	12. 3. 32
		LOT 19.		
Francis Oldall	76	Froggatt Flatt	7 0 28	
Samuel Cooper	77	Stainfield	5 1 16	
Samuel Cooper	77a	Stainfield	3 2 0	
In hand	78	Stainfield Wood	0 2 16	16. 2. 20
		LOT 20.		
Francis Oldall	72	Barker Stubbing	7 0 24	
Do.	73	Barker Stubbing	3 2 32	
Do.	74	Stainfield	7 0 36	18. 0. 12
		LOT 21.		
Francis Oldall	75	Birches	7 1 11	7. 1. 11
		Carried forward		821. 1. 2

TENANT'S NAME	NO. ON PLAN	DESCRIPTION	QUANTITY	TOTALS
		Brought forward	A. R. P.	A. R. P.
		LOT 22.		821. 1. 2
Francis Oldall	34	Birches	6 3 4	
Samuel Cooper	35	Birches	2 1 37	9. 1. 1
		LOT 23.		
Samuel Cooper	28	Bilham Field	2 0 28	
Rebecca Isaacs	29	Tofts	5 2 10	
Do.	30	Tofts	3 3 18	
Do.	31	Tofts	2 3 36	
Do.	32	Goose Lands	2 1 13	
Do.	33	Tofts	3 3 5	
Do.	33a	Little Tofts	1 0 1	21. 2. 28
		LOT 24.		
George Barton & Wm. Wain	36	House and Garden	0 1 10	
William Wain	38	House and Garden	0 0 8	
Samuel Jerrison	39	House and Garden	0 0 16	
Francis Oldall	40	Goose Lands	0 2 32	1. 0. 26
		LOT 25.		
Francis Dalton	69	House and Garden	0 0 10	
George Simmonite	70	House and Garden	0 0 10	
Isaac Watson	71	Garden	0 0 8	0. 0. 28
		LOT 26.		
John Earnshaw & Jas. Riggott	65	Two Houses and Gardens	0 0 20	0. 0. 20
		LOT 27.		
Francis Oldall	66	Farm House, Outbuildings, Yard, and Garden	0 1 20	
Do.	67	Garden	0 0 37	
Do.	68	Croft	2 0 4	2. 2. 21
		LOT 28.		
William Mason	59	Garden	0 0 10	
George Mather	60	House and Garden	0 0 6	
Luke Biggin	61	House and Garden	0 0 17	0. 0. 33
		LOT 29.		
Anthony Barton	49	House and Garden	0 0 39	
Joseph Unwin	50	House and Garden	0 1 28	
Samuel Cooper	51	High Field	2 0 8	
Do.	52	High Field	2 0 26	
Do.	54	High Field	2 1 25	
Do.	55	Farm House and Garden	0 0 39	
Do.	56	Buildings and Yard	0 1 30	7. 3. 35
		LOT 30.		
Thomas Barton	48	House, Shop, and Garden	0 1 27	0. 1. 27
		Carried forward		864. 3. 21

TENANT'S NAME.	NO. ON PLAN.	DESCRIPTION.	QUANTITY.		TOTALS.
			A. R. P.	A. R. P.	
		Brought forward			864. 3. 21
		LOT 31.			
William Mason	57	House, Outbuildings, and Garden	0 1 18		
Do.	58	Garden	0 0 17		
Luke Biggin	61a	Part of Garden	0 0 10		
William Mason	62	Croft	0 2 10		1. 0. 15
		LOT 32.			
William Mason	62a	Part of Croft	0 1 10		
John Vickers	63	Garden	0 0 17		
Do.	64	House, Outbuildings, and Garden	0 1 15		0. 3. 2
		LOT 33.			
Rebecca Isaacs	46	Croft	0 3 0		
Do.	47	House, Outbuildings, and Garden	0 1 32		1. 0. 32
		LOT 34.			
William Mason	42	Jack Flatt	4 1 25		
James Hartley	43	Croft	1 2 0		
Do.	44	House, Outbuildings, and Garden	0 0 13		5. 3. 35
		LOT 35.			
James Hartley	1	Broom Hill	3 2 11		
Samuel Cooper	2	Broom Hill	3 0 4		6. 2. 15
		IN THE PARISH OF NORTON.			
		LOT 36.			
Samuel Bower	650	Yielding Sick	3 1 15		
In hand	652	Plantation	0 0 35		
John Smith	653	Moor Croft	10 0 20		13. 2. 30
		LOT 37.			
In hand	654	Plantation	0 3 10		
Thomas Biggin	655	Common Piece	6 1 6		
Do.	656	Far Common Piece	4 3 14		
Mary Redfern	657	Far Common Piece	3 1 28		
Do.	658	Top Gorsey Row	3 2 22		
Joseph Green	659	Nether Gorsey Row	6 0 20		
Samuel Bower	660	Turnpike Gorsey Row	0 2 26		25. 3. 6
		LOT 38.			
Edward Binney	661	Common Piece	2 2 39		2. 2. 39
		LOT 39.			
Edward Binney	662	Tompin Land	5 2 28		
Do.	664	Upper Low Hedge	2 2 0		
Do.	665	Long Low Hedge	3 1 26		11. 2. 14
		Carried forward			934. 1. 12

TENANT'S NAME.	NO. ON PLAN.	DESCRIPTION.	QUANTITY.		TOTALS.
			A. R. P.	A. R. P.	
		Brought forward			934. 1. 12
		IN THE TOWNSHIP OF COAL ASTON.			
		LOT 40.			
Edward Binney	26	Bowshaw Field	1 1 19		1. 1. 19
		IN THE PARISH OF NORTON.			
		LOT 41.			
William Lister	663	Far Common Field	7 0 36		7. 0. 36
		LOT 42.			
Martha Littlewood	671	House, Garden, and Shop	0 0 25		
Thomas Rhodes	672	House, Garden, and Shop	0 0 32		0. 1. 17
		LOT 44.			
Samuel Staveley	673a	Garden	0 0 27		
John Tyzack	673b	Garden	0 0 26		
William Reaney	673c	Garden	0 0 24		
John Tyzack	673d	Dwelling-House and Yard	0 0 6		
William Reaney	673e	Dwelling-House and Yard	0 0 4		
John Mullins	673f	House, Garden, and Yard	0 0 32		
Samuel Staveley	673g	Dwelling-House and Garden	0 0 11		0. 3. 10
		LOT 45.			
In hand	674	Twenty Well Sick	0 0 5		0. 0. 5
		LOT 46.			
John Fox & Emily Mitchell	432	Two Houses and Gardens	0 0 20		0. 0. 20
		LOT 47.			
John Pearson	425	House and Garden	0 0 26		
Thomas Fox	426	House and Garden	0 0 2		
George Shore	427	House and Garden	0 0 2		
Thomas Hibbert	428	House and Garden	0 0 2		
Thomas Harrison	429	House and Garden	0 0 4		
Samuel Fox	430	Croft	1 0 12		1. 1. 8
		LOT 48.			
Thomas Fox	426a	Garden	0 0 30		
George Shore	427a	Garden	0 0 30		
Thomas Hibbert	428a	Garden	0 0 30		
Thomas Harrison	429a	Garden	0 0 30		0. 3. 0
		LOT 49.			
Samuel Fox	433	House, Smithy, and Garden	0 1 0		
Reaney	433a	House and Garden	0 0 10		
In hand	434	Plantation	0 0 39		0. 2. 9
		LOT 50.			
George Vardy	435	Common Piece	2 1 37		
John Hardwick	436	Allotment	0 1 24		2. 3. 21
		Carried forward			949. 2. 37

TENANT'S NAME	NO. ON PLAN	DESCRIPTION	QUANTITY	TOTALS
		Brought forward	A. R. P.	A. R. P.
				949. 2. 37
		LOT 51.		
James Veale	390	Chauncit	4 2 20	
James Biggin	392	Low Platt Field	1 0 4	
Do.	393	Middle Platt Field	1 3 12	
Do.	394	Yew Tree Field	2 3 17	
Joseph Bingham	395	Great Meadow	4 2 9	
James Veale	396	House, Smithy, and Garden	0 2 15	
Do.	397	Meadow	2 0 32	
Do.	399	Garden	0 0 10	
Do.	400	Two Houses, Smithy, and Garden	0 0 5	
Do.	401	House and Garden	2 1 0	
Do.	402	Jeb Stabbing	1 1 28	
Do.	403	Upper Field	21 0 12	
In hand	404	Chauncit or John Set Wood	5 3 13	
Thomas Biggin	405	High Field	7 2 2	
Do.	406	Cocker Storth	4 3 30	
Do.	407	Quarry Field	1 2 22	
John Cam	408	Two Houses, Quarry, and Brickyard	6 1 0	
Thomas Biggin	409	Briery Field	2 1 16	
Do.	410	Rashy Field	3 3 23	
Do.	411	Knowl Field	5 3 29	
Do.	412	Mear Lands	3 0 0	
Do.	413	Wood Field	5 0 12	
Do.	414	Shepley	1 2 25	
Benjamin Cavill	415	Nether Storth	3 1 8	
Do.	416	Upper Storth	5 2 0	
Do.	417	Shepley	4 3 26	
Thomas Biggin	418	Bull Field	1 0 38	
Benjamin Cavill	419	Turnpike Field	2 0 33	
John Smith	420	Rushy Close	3 2 19	
Do.	421	Shepley	3 1 0	
Do.	422	Meadow	4 3 16	
Do.	423	Great Ley and Quarry	2 2 18	
Do.	424	Little Ley		122. 0. 24
		LOT 52.		
Joseph Bingham	379	Pond Stead	1 1 32	
Do.	380	Pond Stead	1 1 0	
Do.	381	Pond Stead Field	1 3 13	
Do.	382	Pond Stead Field	3 2 10	
Jonathan Youle	383	Top Camp Field	2 1 2	
Do.	384	Low Camp Field	2 0 32	
James Veale	385	Camp Field	1 2 30	
Do.	386	Camp Field	1 3 8	
Jonathan Youle	387	Little Field	2 0 16	
Do.	388	Rough Field	3 0 0	20. 3. 23
		Carried forward		1092. 3. 4

TENANT'S NAME	NO. ON PLAN	DESCRIPTION	QUANTITY	TOTALS
		Brought forward	A. R. P.	A. R. P.
				1092. 3. 4
		LOT 53.		
		No. 372 in this Lot is Leasehold for a term of 800 years, but it is not known either when that term commenced, or what Rent is payable on it, or in whom the Reversion is now vested. No Rent has been paid for it for many years.		
James Veale	369	Green Field	3 1 10	
Do.	370	Orchard	1 2 30	
Do.	371	Farm-House, Outbuildings, and Garden	0 0 26	
Do.	372	House and Garden	0 0 3	
Saml. Redfearn & Ths. Binney	373	Two Houses, Smithy, and Gardens	0 0 8	
James Biggin	(374 & 374a)	Barn and Croft	1 0 10	
Do.	375	House, Smithy, and Garden	0 0 16	
James Bingham	377	Broom Field	3 2 0	
Jonathan Youle	378	Broom Field	4 2 12	14. 1. 25
		LOT 54.		
Samuel Standish	376	House, Garden, and Shops	0 2 6	0. 2. 6
		LOT 55.		
Joseph Bingham	351	Near Hill	3 1 32	
Do.	352	Far Hill	3 3 4	
Do.	353	Holmes	3 0 18	
Jonathan Youle	354	Far Long Lands	3 1 20	
Do.	355	Near Long Lands	2 3 4	
Do.	356	Stoney Lands	3 0 8	
Joseph Bingham	357	Broom Croft	1 3 36	
Do.	358	Orchard	0 0 36	
Do.	359	Stack Yard	0 1 4	
Do.	360	New Intake	0 1 24	
Do.	361	Barn and Yard	0 0 33	
Do.	362	Garden	0 0 20	
Jonathan Youle	363	House and Garden	0 0 36	
Do.	364	Garden	0 0 13	
Do.	365	Intake	0 2 4	
Do.	366	Barn and Stack Yard	0 0 23	
Joseph Bingham	367	House, Smithy, and Garden	0 0 25	
Do.	368	Lathe Field	3 2 13	27. 1. 53
		LOT 56.		
Mrs. Seddon	303	Garden	0 0 18	
Do.	304	Public-House, Yard, and Outbuildings	0 1 32	
Do.	305	Marsh	1 1 31	2. 0. 1
		LOT 57.		
		No. 340 in this Lot is Leasehold for a term of 800 years, created by an indenture bearing date on or about the 25th day of September, 1679, but it is not known what rent is payable thereon, or on whom the Reversion is now vested. No rent has been paid on it for many years.		
Thomas Binney	306	Garden	0 0 21	
William Biggin	307	Garden	0 0 20	
		Carried forward		1137. 0. 29

TENANT'S NAME.	NO. ON PLAN.	DESCRIPTION.	QUANTITY.	TOTALS.
		Brought forward ...	A. R. P.	A. R. P.
			1137. 0. 29	
LOT 57.—CONTINUED.				
Edmund Kilner ...	308	Garden ...	0 1 0	
William Swift ...	309	Garden ...	0 1 3	
Thomas Cavill ...	310	Garden ...	0 0 20	
Mary Birch ...	311	Garden ...	0 0 20	
George Reaney ...	312	Garden ...	0 0 20	
Benjamin Thickett ...	313	Garden ...	0 0 20	
William Reaney ...	314	Garden ...	0 0 20	
Joseph Reaney ...	315	Garden ...	0 0 21	
Thomas Needham ...	316	Garden ...	0 0 26	
Joseph Reaney ...	317	Garden ...	0 0 20	
Edm. Kilner & Wm Whitehead ...	318	Garden ...	0 0 20	
Jph. Thickett & Hy. Thorpe ...	319	Garden ...	0 0 21	
James Ward ...	320	Garden ...	0 0 24	
Henry Thorpe ...	321	Garden ...	0 0 12	
Mark Havenhand, Thomas Osborne, Joseph Hopkinson, and others ...	340	Three Shops, Outbuildings, and Garden ...	0 0 13	
Joseph Hopkinson ...	344	Dwelling-House, Shop, Outbuildings, and Garden ...	0 0 3	
Thomas Needham and Wm. Whitehead ...	345	Two Houses and Outbuildings ...	0 0 7	
Joseph Hopkinson ...	346	Outbuildings and Gardens ...	0 0 19	
Elizabeth Savage ...	347	Dwelling-House, Outbuildings, and Garden ...	0 0 19	
Joseph Bingham ...	348	Farm-House, Outbuildings, Yard, and Lane ...	0 0 24	
Do. ...	349	Garden ...	0 2 10	3. 2. 3
Do. ...	350	Orchard ...		
LOT 58.				
The whole of this Lot is Leasehold, under the same term as No. 340, in the preceding Lot.				
Joseph Bingham ...	322	Stack Yard ...	0 0 10	
Elizabeth Savage ...	322a	Cart Shed and Piggy ...	0 0 3	
Joseph Hopkinson ...	323	Workshops and Yard ...	0 0 15	
Do. ...	324	Outbuildings and Garden ...	0 0 7	
Chas. Ratcliffe & Jph. Marsden ...	325	Two Houses and Garden ...	0 0 9	
Thomas Needham ...	326	Garden ...	0 0 4	
Joseph Hilbert ...	327	House and Garden ...	0 0 11	
Henry Thorpe ...	328	House and Garden ...	0 0 10	
Joseph Hopkinson ...	330	Garden ...	0 0 24	
Ann Vane ...	331	House and Garden ...	0 0 3	
Joseph Reaney ...	332	Garden ...	0 0 4	0. 2. 20
LOT 59.				
The whole of this Lot is Leasehold, under the same term as the preceding one.				
Joseph Reaney ...	332a	House ...	0 0 3	
Charles Ratcliffe ...	333	Garden ...	0 0 3	
Benjamin Thickett ...	334	Outbuildings and Garden ...	0 0 7	
Joseph Hopkinson ...	335	Woodseat Croft ...	1 2 26	
Edmund Kilner ...	336	House, Shop, and Garden ...	0 0 10	
Carried forward ...				1141. 1. 12

TENANT'S NAME.	NO. ON PLAN.	DESCRIPTION.	QUANTITY.	TOTALS.
		Brought forward ...	A. R. P.	A. R. P.
			1141. 1. 12	
LOT 59.—CONTINUED.				
James Ward ...	337	House and Garden ...	0 0 2	
Benjamin Thickett ...	338	Two Houses and Garden ...	0 0 2	
Mark Havenhand ...	339	House and Garden ...	0 0 8	1. 3. 21
LOT 60.				
Joseph Bingham ...	274	Upper Field ...	3 0 19	
Do. ...	275	Far Nether Field ...	1 1 38	
Do. ...	276	Near Nether Field ...	1 2 22	6. 0. 39
LOT 61.				
Miss Savage ...	277	Near Rough Field ...	2 1 20	
Do. ...	278	Rough Field ...	2 3 10	
Do. ...	279	Carr Pasture ...	2 3 36	
Do. ...	280	Carr Pasture ...	2 2 16	10. 3. 2
LOT 62.				
Mrs. Seddon ...	281	Nether Carr ...	2 0 24	
Do. ...	282	Nether Carr ...	2 1 24	
Do. ...	284	Upper Carr ...	3 3 39	8. 2. 7
LOT 63.				
Joseph Bingham ...	285	Wood Field ...	2 2 24	
Do. ...	286	Carr Field ...	1 2 0	
Do. ...	287	Little Field ...	1 0 10	
Do. ...	288	Carr Field ...	2 3 13	
Do. ...	289	Well Carr ...	1 0 26	
Do. ...	293	Turnpleck ...	4 1 9	
Do. ...	294	Garden ...	0 0 5	
Do. ...	295	Garden ...	0 0 8	
Do. ...	296	Stack Yard ...	0 0 23	13. 2. 38
LOT 64.				
Robert Linley ...	217	Wainwright Field ...	7 3 32	
Do. ...	255	Homestead ...	3 3 9	
Do. ...	256	House, Smithies, and Garden ...	0 2 4	
R. Linley & Widow Hobson ...	257	Two Houses and Gardens ...	0 0 4	
Thos. Turner & Jph. Greaves ...	258	Two Houses and Gardens ...	0 0 24	
Robert Bingham ...	259	New Gardens ...	0 0 15	
Robert Linley ...	262	Garden ...	0 0 5	
Joseph Marsden ...	263	Garden ...	0 1 13	
Robert Linley ...	264	Garden ...	0 0 5	
Do. ...	265	Three Cottages and Gardens ...	0 0 16	
Samuel Cocker ...	266	House and Garden ...	0 0 10	
Do. ...	267	Croft ...	0 0 37	
Joseph Greaves ...	268	Lingfoot Field ...	3 0 10	
Do. ...	270	Pasture Field ...	1 2 6	
Do. ...	271	Middle Field ...	2 0 28	
Joseph Marsden ...	272	Low Field ...	3 0 33	
In hand ...	273	Lee Carr and Bole Hill Wood ...	13 1 32	
George Cavill ...	290	Garden ...	0 0 24	
Miss Savage ...	292	Little Field ...	0 2 0	37. 1. 27
Carried forward ...				1219. 3. 26

TENANT'S NAME	NO. ON PLAN.	DESCRIPTION.	QUANTITY.	TOTALS.
			A. R. P.	A. R. P.
		Brought forward ...		1219. 3. 26
		LOT 65.		
Pharbe Cavill ...	(511) (512)	Bunting Nook ...	4 3 11	
Thomas Linley ...	513	Coal Pit Field ...	3 1 16	
John Bingham ...	514	Common Piece ...	0 1 12	
Do. ...	515	Back Moor Field ...	1 2 27	
Do. ...	516	Delph Field ...	2 0 31	
Joseph Atkin ...	517	Dove Lands ...	2 2 23	
William Gascoigne ...	518	Play Ground ...	0 2 19	
Do. ...	519	Garden ...	0 1 18	
Do. ...	520	First Field ...	1 0 16	17. 0. 13
		LOT 66.		
Job Flakemoor ...	239	House, Smithy, and Garden ...	0 0 26	0. 0. 26
		LOT 67.		
In hand ...	199	Wood ...	2 1 12	
Robert Linley ...	218	Far Field ...	2 0 4	
Do. ...	219	Near Field ...	2 3 10	
Do. ...	220	Meadow ...	2 1 3	
George Oates ...	221	House and Garden ...	0 0 22	
Robert Linley ...	222	Hill Side ...	3 1 31	
Do. ...	223	Near Riddings ...	1 3 12	
Do. ...	224	Far Riddings ...	1 3 24	
Thomas Linley ...	226	Riddings ...	11 0 38	
Do. ...	230	Harvey Clough ...	4 1 8	
Do. ...	231	Spring Field ...	6 2 14	
Do. ...	232	Footway Field ...	6 1 10	
Do. ...	233	Long Field ...	4 3 14	
Do. ...	234	Great Bent ...	8 1 24	
Do. ...	235	Great Gill Field ...	8 3 14	
Do. ...	236	Bank ...	5 0 4	
Do. ...	237	Little Beast Hill ...	3 1 1	
Do. ...	238	Great Beast Hill ...	8 1 4	
Joseph Bunting ...	240	Brecks ...	4 1 31	
John Bingham ...	241	Well Field ...	0 1 39	
Thomas Linley ...	242	Garden ...	0 0 10	
Do. ...	243	House and Garden ...	0 0 23	
Do. ...	244	House, Smithy, and Garden ...	0 0 21	
Do. ...	245	Sheep Hill Croft ...	4 0 24	
Do. ...	246	Square Bent ...	6 0 39	
Do. ...	247	Croft ...	4 1 2	
Do. ...	248	Ponds ...	0 1 12	
Do. ...	249	Farm-House, Outbuildings, and yard ...	0 3 10	
In hand ...	253	Plantation ...	0 1 2	
Thomas Linley ...	250	Road ...	0 1 36	
Do. ...	251	Garden Field ...	6 3 17	
Do. ...	252	Garden ...	0 0 39	
Do. ...	254	Turnpike Field ...	6 1 26	
In hand ...	269	Quarry and Allotment ...	1 0 1	120. 0. 31
		Carried forward ...		1357. 1. 16

TENANT'S NAME	NO. ON PLAN.	DESCRIPTION.	QUANTITY.	TOTALS.
			A. R. P.	A. R. P.
		Brought forward ...		1357. 1. 16
		LOT 68.		
Widow Paley ...	174	Garden ...	0 0 12	
Miss Thorpe ...	176	Nether Croft ...	3 0 2	
Do. ...	184	Smithy Croft and Plantation ...	1 0 25	
Do. ...	185	Outbuildings and Yard ...	0 0 23	
Do. ...	186	Farm House and Garden ...	0 0 4	
Do. ...	188	Upper Croft and Plantation ...	3 1 5	
Do. ...	190	Mansion-House comprising Dining, Drawing, and Breakfast Rooms, Library, Kitchens, Cellars, and eight good Lodging Rooms; with Carriage-House, Stables, Outbuildings, Yard, Vinery, and Garden ...	0 3 32	
In hand ...	191	Plantation and Waste ...	0 0 38	
Do. ...	192	Plantation ...	0 0 3	
Miss Thorpe ...	193	Far Croft ...	7 2 33	
Do. ...	195	Pasture Field ...	5 0 0	
In hand ...	196	Woody ...	0 1 24	
Miss Thorpe ...	197	Long Field Bottom ...	1 2 32	
In hand ...	198	Woody Bank ...	0 3 4	
Miss Thorpe ...	200	Great Field ...	6 0 22	
Do. ...	201	Nether Square Field ...	3 1 8	
Do. ...	202	Long Field ...	3 1 13	
Do. ...	203	Brickyard Field ...	4 0 23	
Do. ...	204	Great Square Field ...	2 2 7	
Do. ...	206	Foot Ball Field ...	3 2 16	47. 2. 6
		LOT 69.		
Rev. Percival Bowen and Richard Gillatt ...	133	Mansion House comprising Dining and Drawing Rooms, Library, Kitchens, Cellars, and eleven Lodging Rooms; with Carriage-House, Stables, Gardens, and Farm Buildings ...	1 2 39	
Richard Gillatt ...	166	Great Well Dole ...	9 0 33	
Rev. Percival Bowen ...	167	House and Garden ...	0 0 4	
Robert Gillatt ...	168	Garden ...	0 0 7	
Do. ...	169	Garden ...	0 0 7	
Do. ...	170	House, Shop, and Garden ...	0 1 9	
Do. ...	171	Garden ...	0 0 6	
Do. ...	172	Little Well Dole ...	1 1 37	
Joseph White ...	173	Croft ...	1 2 4	
Richard Gillatt ...	207	Upper Six Lands ...	7 2 14	
Do. ...	209	Nether Six Lands ...	9 0 24	
Do. ...	210	Upper Well Dole ...	7 2 4	38. 2. 28
		LOT 70.		
Richard Gillatt & Jarvis Kay ...	134	Farm House, Outbuildings, Shop, and Garden ...	0 1 26	
Richard Gillatt ...	135	Lamb Croft ...	3 2 32	
Do. ...	138	Upper Lamb Croft ...	4 3 20	
Joseph Greaves ...	137a	Part of Long Field ...	0 1 6	
Robert Gillatt ...	159	Nether Pasture ...	1 0 14	
Do. ...	161	Garden ...	0 0 31	
Do. ...	162	Nether Pasture ...	1 2 24	
		Carried forward ...		1443. 2. 10

TENANT'S NAME.	NO. ON PLAN.	DESCRIPTION.	QUANTITY.	TOTALS.
			A. R. P.	A. R. P.
		Brought forward		1443. 2. 10
		LOT 70—CONTINUED.		
Richard Gillatt ...	164	Garden	0 0 12	
Do. ...	165	Croft	1 0 14	
Do. ...	208	Top Field	4 1 24	
Do. ...	211	Middle Field	2 1 15	
Robert Gillatt ...	212	Upper Pasture	2 3 24	
Joseph Greaves ...	213	Cooper Field	3 1 18	26. 1. 20
		LOT 71.		
Sampson Loukes ...	153	House, Outbuildings, and Garden	0 0 34	
William Biggin ...	154	Garden	0 0 6	
Do. ...	155	House and Garden	0 0 3	
Widow Birch ...	156	House and Garden	0 0 3	
Do. ...	157	Garden	0 0 3	
Sampson Loukes ...	158	Cricket Field	4 1 37	
Do. ...	214	Above Cricket Field	1 2 19	6. 1. 25
		LOT 72.		
Sampson Loukes ...	149	Garden	0 0 39	
Sarah Bingham ...	150	House and Garden	0 0 12	
Sampson Loukes ...	151	Outbuildings and Yard	0 0 8	
Do. ...	152	Low Shipley	2 1 16	
Do. ...	215	Middle Shipley	2 0 13	
Do. ...	216	Far Shipley	2 0 10	6. 3. 18
		LOT 73.		
		No. 67 in this Lot is Leasehold for a term of 800 years, created by an indenture bearing date on or about the 20th day of November 1724, but it is not known what rent is payable thereon, or in whom the reversion is now vested. No rent has been paid for it for many years.		
In hand ...	66	Part of Upper Smithy Wood	2 2 13	
Charlotte Reaney and others	67	Four Cottages	0 0 10	
Joseph Greaves ...	68	Croft	1 2 29	
Do. ...	69	Webster	1 3 28	
Do. ...	70	Upper Webster	2 2 3	8. 3. 3
		LOT 74.		
Thomas Osborne ...	60	Far Wood Field	2 0 8	
Do. ...	61	Middle Wood Field	2 0 17	
Do. ...	64	Dwelling-House, Workshops, and Garden	0 0 36	
Saml. Gillatt & Widow Kilner	65	Two Houses, Shops, and Garden	0 0 14	4. 1. 35
		LOT 75.		
William Moore ...	44	Below Wood	3 2 9	
Do. ...	45	Field back of the Wood	3 3 26	
In hand ...	46	Gillatt's Wood	2 2 28	
Do. ...	47	Wood and Quarry	4 1 38	
William Moore ...	48	High Field	5 2 5	
Do. ...	49	Far Flat	1 1 33	
		Carried forward		1496. 1. 31

TENANT'S NAME.	NO. ON PLAN.	DESCRIPTION.	QUANTITY.	TOTALS.
			A. R. P.	A. R. P.
		Brought forward		1496. 1. 31
		LOT 75.—CONTINUED.		
William Moore ...	50	Near Flat	2 3 39	
Do. ...	51	Dam Close	1 0 24	
Do. ...	52	Garden	0 2 4	
Do. ...	53	Two Houses and Gardens	0 0 23	
Do. ...	55	House, Barn, Stable, Outbuildings, and Garden	0 1 9	
Do. ...	56	Stackyard	0 0 19	
Do. ...	54	Orchard	0 1 4	
Do. ...	57	Barn Croft	2 0 36	
Do. ...	58	Calf Meadow	2 1 36	
Do. ...	59	Meadow	4 0 15	35. 3. 28
		B. B. P. Burnell, Esq., claims a Right of Pasturage on No. 46 in this Lot, after the Wood therein has been felled seven years.		
		LOT 76.		
Unoccupied ...	1	Garden	0 0 15	
In hand ...	2	Mariott Wood	8 2 20	
Hunt and Brown ...	3	Fire Brick Yard, &c.	0 1 8	9. 0. 3
		The Vicar of Norton claims a Right for the Vicar of Norton for the time being, to the Pasturage in No. 2 in this Lot, after the Wood therein has been felled seven years.		
		LOT 77.		
Webster's Executors ...	28	Garden	0 0 31	
Do. ...	29	Garden	0 0 26	
Do. ...	30	Garden	0 0 28	
Robert Jackson ...	31	Well Croft	0 2 14	
Wm. Moore & Robt Jackson	32	Houses, Shops, and Gardens	0 0 32	
William Moore ...	33	Norton Hammer Grinding Wheel and Buildings	0 2 22	
Do. ...	35	Dam	0 1 8	
Do. ...	41	Top Dam	0 3 36	
Do. ...	34	Garden	0 0 29	
Do. ...	36	Garden	0 0 31	
Robert Jackson ...	42	Great Meadow	1 1 36	
William Moore ...	43	Island	0 1 36	5. 2. 9
		LOT 78.		
Robert Jackson ...	37	House, Outbuildings, and Yard	0 0 16	
Do. ...	38	Garden	0 0 20	
Do. ...	39	Barn Croft	0 2 17	
Do. ...	40	Dam Croft	1 0 28	
Do. ...	62	Near Wood Field	1 2 15	
Do. ...	63	Near Wood Field	1 2 10	
In hand ...	63a	Part of Smithy Wood	1 1 2	6. 1. 28
		LOT 79.		
Late Mr. R. Brownell ...	71	Nether Webster	2 1 39	
Do. ...	72	Barn Croft	4 0 18	
In hand ...	72a	Part of Smithy Wood	2 3 7	
		Carried forward		1553. 1. 19

TENANT'S NAME	NO. ON PLAN	DESCRIPTION	QUANTITY		TOTALS
			A. R. P.	A. R. P.	
		Brought forward			1553. 1. 19
		LOT 79.—CONTINUED.			
Late Mr. R. Brownell	139	Storch and Plantation	7 0 24		
Do.	141	Mansion House comprising Dining, Drawing, and Breakfast Rooms, eight Lodging Rooms, Kitchens, and Cellars; with Stables, Carriage House, Pleasure Ground, Garden, Cottage House, and Outbuildings	1 1 0		
Richard Gillatt	143	Cliffe Field	5 3 9		23. 2. 17
		LOT 80.			
Joseph Greaves	136	Little Croft	1 1 35		
Do.	137	Long Field	1 1 12		
Richard Gillatt	138a	Part of Upper Lamb Croft	0 3 17		
Do.	143a	Part of Cliffe Field	0 3 5		
Joseph Greaves	144	Four Lane End Field	3 0 14		
Do.	146	Barn, Smithy, and Yard	0 0 14		
Do.	147	Two Houses and Garden	0 0 14		
Henry Payne & Hy. Hartley	148	Two Houses, Smithies, and Garden	0 0 25		7. 3. 16
		LOT 81.			
Miss Brittain	180	Mansion House comprising Dining and Drawing Rooms, Kitchens, Cellars, and six Lodging Rooms; with Stable, Carriage House, Cottage, Outbuildings, Garden, and Pleasure Ground	0 3 27		
Do.	181	Gardens	0 0 35		
Do.	182	Croft	2 1 15		
Do.	183	Plantation	0 0 4		3. 2. 1
		LOT 82.			
Richard Booker	102	Upper and Lower Range	6 2 8		
Ann Bingham	103	Low Carr	4 2 7		
Do.	104	Little Field	1 3 32		
Do.	105	Far Field	2 2 39		
Do.	106	Croft	0 2 8		
Do.	107	Farm House, Outbuildings, and Garden	0 0 19		
Do.	108	Upper Carr	3 2 38		
Richard Booker	109	Storch	6 2 12		26. 3. 3
		LOT 83.			
Jas. Barnes & Robt. Smith	95	Two Cottages and Gardens	0 1 0		
Joseph White	96	Bottoms	3 0 16		
Do.	97	Meadow	3 2 28		
Do.	98	Huckerback	4 2 20		
Do.	99	Upper Wright	3 0 36		
Do.	100	Lower Wright	2 0 27		
Richard Booker	101	Wright Field	4 1 26		
Do.	110	East Wood Meadow	5 3 19		
Do.	111	Pond Meadow	5 1 4		32. 2. 16
		Carried forward			1647. 2. 32

TENANT'S NAME	NO. ON PLAN	DESCRIPTION	QUANTITY		TOTALS
			A. R. P.	A. R. P.	
		Brought forward			1647. 2. 32
		LOT 84.			
Joseph White	92	Spring Field	5 1 39		
Do.	93	Stoney Hills	6 3 30		
Do.	94	Meersbrook	6 1 16		
Do.	112	Croft	3 1 26		
Do.	113	Farm-House, Outbuildings, and Garden	0 2 15		
Stephen Cavill	114	House and Garden	0 0 15		
George Wastnidge	115	House and Garden	0 0 13		
Joseph White	116	Stack Yard and Buildings	0 1 7		23. 1. 1
		LOT 85.			
Widow Paley	117	House, Shop, and Garden	0 0 6		
Mary Ratcliffe	118	House and Garden	0 0 31		
Mrs. Parker	119	Mansion House comprising Dining, Drawing, and seven Lodging Rooms, with Kitchen and Cellar, Stables, Carriage House, Outbuildings, Yard, Garden, and Pleasure Ground	0 2 17		
Do.	126	Croft	0 3 2		
Jarvis Kay	128	Garden	0 0 12		
Miss Brittain	129	Garden	0 0 16		
Stephen Cavill	130	Garden	0 0 17		
George Wastnidge	131	Garden	0 0 17		
Rev. P. Bowen	132	Nether Lamb Croft	3 3 24		
Do.	132a	Nether Lamb Croft	2 3 25		8. 3. 10
		LOT 86.			
Miss Shore	139a	Part of Storch	1 1 7		1. 1. 7
		LOT 87.			
Webster's Executors	2	Bank	2 2 24		
Do.	3	Little London Dam	6 0 16		
Do.	4	Little London Works, Houses, and Gardens	0 3 4		
Do.	5	Houses and Gardens	0 1 4		
Do.	21	Rough Field	3 3 29		
In hand	23	Plantation	0 2 4		
Webster's Executors	24	Smithy Wood Bottom Works	0 2 4		
Do.	26	Dam	2 1 6		
Do.	25	Cottage and Garden	1 0 8		
Do.	27	Meadow	1 0 3		
		The foregoing portions of this Lot are sold subject to a Lease thereof to Mr. Thomas Biggin, for 84 years, from Lady-Day 1789, upon which a Rent of £84 per Annum is payable.	19 0 13		
In hand	1	Plantation (in Ecclesall Bierlow)	0 0 30		
Webster's Executors	6	Meadow	2 0 26		
Do.	15	Dam Field	0 1 32		
Do.	16	First Field	3 2 0		
In hand	17	Plantation	0 0 23		
Webster's Executors	18	Brick Field	3 3 36		
In hand	22	Smithy Wood	7 2 8		37. 0. 8
		Carried forward			1718. 0. 18

TENANT'S NAME	NO. ON PLAN	DESCRIPTION	QUANTITY	TOTALS
		Brought forward	A. R. P.	A. R. P.
			1718. 0. 18	
		LOT 88.		
William Moore	20a	Smithy Wood Field	3 2 0	3. 2. 0
		LOT 89.		
William Moore	20	West Well Field	3 2 2	3. 2. 2
		LOT 90.		
William Moore	19	East Well Field	2 2 12	2. 2. 12
		LOT 91.		
John Hall	11	Garden	0 1 1	
Do.	12	House, Shop, and Garden	0 0 24	
Do.	13	Garden	0 1 26	
				0. 3. 11
		LOT 92.		
Mary and James Brailsford	7	New Dam	1 1 12	
Do.	8	Old Dam	0 2 24	
Do.	9	Heeley Mill, House, Yard, &c.	0 3 12	
Do.	10	Garden	0 0 39	
Do.	14	Dam Field	1 0 16	
				4. 0. 23
TOTAL of NORTON and COAL ASTON ESTATE, Map No. 1				1732. 2. 26

LOT 93.

The following LEASEHOLD CHIEF and COTTAGE RENTS, payable out of HEREDITAMENTS in the Parish of NORTON, and Township of COAL ASTON, in the Parish of DRONFIELD:—

(The Numerical References in this List are used for the purpose of arrangement only, and do not refer to any of the annexed Maps.)

NO.	OWNER OF HEREDITAMENTS OUT OF WHICH THE RENTS ARE PAYABLE.	OCCUPIERS OF HEREDITAMENTS OUT OF WHICH THE RENTS ARE PAYABLE.	SITUATION OF HEREDITAMENTS OUT OF WHICH THE RENTS ARE PAYABLE.	AMOUNT.
1	Robert Bingham	Himself	Bolehill	0 6 8
2	Executors of William Bingham	Themselves	Woodseats	0 19 6
3	Do.	Do.	Do.	0 0 6
4	B. B. P. Burnell	Widow Hall	Bradway	0 1 7
5	Representatives of John Charge	George Vardy	Greenhill	0 10 3
6	B. B. P. Burnell	Michael Norton	Greenhill	0 5 8
7	J. M. Salisbury		Holmhurst	0 1 0
8	B. B. P. Burnell	Samuel Gillatt	Woodseats	2 0 8
9	Captain Glossop	Robert Booker	Lees Hall	0 10 4
10	Representatives of John Charge	Henry Horridge	Greenhill	0 10 3
11	Lindley and Sampson	Widow Atkin	Lightwood	0 0 10
12	William Spooner	Himself	Heeley	0 0 8
13	Representatives of John Charge	Jonathan Turner	Woodseats	
14	Do.	William Swift	Do.	0 6 4
15	Do.	William Frith	Do.	
16	Samuel Bower	Himself	Dyke Lane	0 1 8
17	James Fidler	Himself	Coal Aston	0 7 0
18	Charles Thorold		Coal Aston	0 3 0
				£6 5 11

The above-mentioned Rent numbered 3 is reserved upon a term of 500 years, from Michaelmas 1700, in a House and the Appurtenances at Woodseats, in the occupation of the Representatives of the late Mr. William Bingham, the Freehold Reversion in which will be Sold with the Rent.

The above-mentioned Rent numbered 8, is reserved upon a Lease for a long term of years, the duration of which is not known, in a Farm at Woodseats, in the occupation of Mr. Samuel Gillatt, as tenant thereof to B. B. P. Burnell, Esq., the Freehold Reversion in which will be Sold with the Rent.

The Remainder of the above-mentioned Rents are Chief or Cottage Rents.

LOT 94.

The MINES or BEDS of COAL, IRONSTONE, and other MINERALS (except Stone,) in or under the following LANDS, in the Township of COAL ASTON; which Mines and Beds, with powers of getting the same, were reserved to Samuel Shore, Esq., deceased, under the Enclosure Act for the Manor of Norton, as the Lord of that Manor:—

NO. ON PLAN.	OWNERS OF LAND.	OCCUPIERS OF LAND.	QUANTITY OF LAND.
1	Robert Ward	— Davenport	A. R. P.
2	Charles Thorold	Jonathan Ashton	4 2 33
3	Do.	Do.	5 1 0
4	— Rhodes	Himself	0 1 6
			2 3 26
			13 0 25

IN THE COUNTY OF DERBY.

ESTATE

IN THE TOWNSHIPS OF TOTLEY AND DORE, IN THE PARISH OF DRONFIELD.

ON FRIDAY the 5th day of JULY 1850 the following Lots Numbered from 1 to 15 both inclusive (the Land comprised in which is shewn in Map 2, annexed to these Particulars,) will be offered for Sale in one Lot, and if not Sold in that manner will on the same day be put up for Sale in the following 15 Lots:—

The Mines of Coal and Ironstone within and under the Commons and Waste Grounds inclosed by virtue of the Totley Inclosure Act, together with Liberty of working the same were by that Act reserved to the Right Hon. Digby Lord Middleton, Lord of the Manor of Totley; all such parts of the following 15 Lots as were formerly Common or Waste Grounds, inclosed under the authority of the said Act, will therefore be sold subject to that reservation.

TENANT'S NAME.	NO. ON PLAN.	DESCRIPTION.	QUANTITY.	TOTALS.
IN THE TOWNSHIP OF TOTLEY.			A. R. P.	A. R. P.
LOT 1.				
In hand ...	1	Plantation (Dore Gate) ...	15 3 0	
Duke of Rutland ...	2	Bole Hill Lodge, Moor Land including Shooting Ground, containing Fire Clay and Gannister Stone ...	149 0 11	164. 3. 11
IN THE TOWNSHIP OF DORE.				
LOT 2.				
Ann White ...	3	Hough Field ...	2 3 24	2. 3. 24
IN THE TOWNSHIP OF TOTLEY.				
LOT 3.				
Robert Pinder ...	4	Taylor Hill Close ...	2 3 26	
Do. ...	5	Flatt ...	3 3 16	
Do. ...	6	Foot Ball Field ...	2 3 0	
Do. ...	7	New Piece ...	2 2 32	12. 0. 34
IN THE TOWNSHIP OF TOTLEY.				
LOT 4.				
John Mitchell ...	8	Near Upper Field ...	1 3 26	
Do. ...	9	Far Upper Field ...	2 1 13	
Do. ...	10	Great Bank ...	2 0 21	
Robert Pinder ...	11	Paper Mill Field, or Far Field ...	2 1 8	
Robert Elliott ...	12	Mill Race, for which Messrs. Elliott and Ogden pay £5 per Annum as Stream Rent, and Land adjoining, including Half of Brook ...	0 1 14	
Robert Pinder ...	13	Smelting House Field, or Pasture Field ...	1 3 38	
Do. ...	14	Far Great Field ...	2 1 12	
Do. ...	15	Knowl Field ...	1 2 31	
John Mitchell ...	16	Little Bank ...	1 0 18	
Do. ...	17	Long Field ...	2 2 26	
Robert Pinder ...	18	Butler Field ...	1 3 19	
John Mitchell ...	19	Far Croft ...	0 0 39	
Robert Pinder ...	20	Outbuildings and Yards ...	0 0 17	
Do. ...	21	Lane ...	0 0 9	
Do. ...	22	Stack Yard ...	0 0 19	
Do. ...	23	Great Rushy Field, or Barn Field ...	2 1 8	
Do. ...	24	Rushy Field ...	3 2 37	27. 0. 35
Carried forward ...				207. 0. 24

TENANT'S NAME.	NO. ON PLAN.	DESCRIPTION.	QUANTITY.	TOTALS.
		Brought forward	A. R. P.	A. R. P.
				207. 0. 24
IN THE TOWNSHIP OF DORE.				
LOT 5.				
Ann White	25	Great Field	4 3 25	
Do.	26	Bridge Field	4 1 34	
Do.	27	Bottoms, including Half of Brook	1 1 8	
In hand	27a	Plantation	0 0 11	
Ann White	28	Barn Field	2 2 4	
IN THE TOWNSHIP OF TOTLEY.				
In hand	29	Bushes	0 0 11	13. 1. 13
IN THE TOWNSHIP OF DORE.				
LOT 6.				
In hand	30	Vacant Ground	0 0 39	
IN THE TOWNSHIP OF TOTLEY.				
In hand	31	Vacant Ground, including Brook	0 1 11	0. 2. 10
IN THE TOWNSHIP OF TOTLEY.				
LOT 7.				
John Mitchell	32	Gorse Bent Ley	4 0 2	
Do.	33	Nether Bent Ley	3 3 1	
John Mitchell and another	34	House and Garden	0 0 8½	
Do.	35	House and Garden	0 0 10	
John Mitchell	36	Upper Bent Ley and Intake	4 3 0	12. 2. 2½
IN THE TOWNSHIP OF TOTLEY.				
LOT 8.				
Samuel Pearson	37	Hare Croft	1 3 10	1. 3. 10
IN THE TOWNSHIP OF TOTLEY.				
LOT 9.				
Samuel Pearson	38	Upper Hare Croft	1 2 29	
Do.	39	Lower Hare Croft	3 1 22	
Do.	40	Part of Summer Lane	0 2 6	5. 2. 17
IN THE TOWNSHIP OF TOTLEY.				
LOT 10.				
Ann White	41	Part of Little Croft	0 1 30	
Thomas Bunting	42	Part of Little Croft	0 0 24	
Ann White	43	Barn Croft	0 3 8	1. 1. 22
IN THE TOWNSHIP OF TOTLEY.				
LOT 11.				
Ann White	44	The Bank	3 1 2	
Robert Pinder	45	Long Storth Bank	2 0 17	
Do.	46	Leenly	3 2 21	
Do.	47	Near Bank	3 1 0	
Ann White	48	Crimbles	1 1 9	13. 2. 9
Carried forward				
				256. 0. 6½

TENANT'S NAME.	NO. ON PLAN.	DESCRIPTION.	QUANTITY.	TOTALS.
		Brought forward	A. R. P.	A. R. P.
				256. 0. 6½
IN THE TOWNSHIP OF TOTLEY.				
LOT 12.				
Robert Pinder	49	Town Croft	0 2 12	0 2. 12
IN THE TOWNSHIP OF TOTLEY.				
LOT 13.				
Job Green	50	Outbuildings and Yard	0 0 27	
Samuel Pearson	50a	Road	0 0 15½	
Ann White	51	House, Outbuildings, and Yard	0 0 39	
Job Green	52	House, Outbuildings, Yard, and Gardens	0 0 14	
Do.	53	Croft	0 1 16	
Samuel Pearson	54	Lane	0 0 7	
Do.	56	Croft	0 1 0	
Do.	55	House, Outbuildings, Yard, and Gardens	0 2 13	
Do.	57	Part of the Hough	2 1 28	
Do.	58	Part of the Hough	3 3 34	
Do.	59	Croft	0 3 7	
Job Green	60	Croft and Scargill Dole	1 1 24	
Samuel Pearson	61	New Close and Little North Furlong	2 2 26	
Do.	62	Little North Furlong	2 0 22	
Job Green	63	North Furlong	4 1 36	
Ann White	64	North Furlong	4 0 2	
Do.	65	Brookhouse Field	2 2 17	
In hand	66	Hickley Bank Wood	4 2 31	
Job Green	67	Hickley Bank Field	3 2 31	
Do.	68	Bare Lands	1 3 38	
Do.	69	Bare Lands	2 2 21	
Do.	70	Far West Field	1 2 22	
Ann White	71	Near Wet Lands	1 3 12	
Job Green	72	Limekiln Close	3 0 12	45. 3. 14½
IN THE TOWNSHIP OF TOTLEY.				
LOT 14.				
Samuel Pearson	73	Ashmore Breast Barn Close	1 0 30	
Do.	74	Upper Breast Barns	1 2 9	
Do.	75	Lower Breast Barns	1 0 33	
Do.	76	Red Wells	4 1 29	
Do.	77	Gilling Storth "	4 0 16	12. 1. 37
TOTAL of TOTLEY and DORE ESTATE, Map No. 2...				
				314. 3. 30

LOT 15.

A RENT-CHARGE of £21. 15s. 11d. per Annum, at which the RECTORIAL TITHES payable to Mr. Shore, in the Township of Totley, have been commuted under the Totley Tithe Apportionment Agreement, and which is apportioned upon the Lands in that Township, and in the Sums following:—

NAMES OF OWNERS OF LAND OUT OF WHICH TITHES ARE PAYABLE.	WHERE LANDS ARE SITUATE.	QUANTITY OF LAND.			AMOUNT OF ANNUAL CHARGE.			
		A.	R.	P.	£.	s.	d.	
Barker, Ann	Totley	0	1	7	0	0	5	
Barton, Joseph	Do.	2	2	9	0	3	10	
Brookfield, Charles	Do.	5	0	6	0	4	9	
Bunting, Thomas	Do.	2	0	19	0	2	8	
Cook, D'Ewes	Do.	140	1	21	5	10	9	
Dalton, William	Do.	2	2	30	0	2	6	
Dalton, Thomas	Do.	1	0	30	0	1	10	
Elliott, Alm. and J.	Do.	7	2	3	0	2	4	
Greaves, George	Do.	112	0	74	11	7	7	
Middleton, Lord	Do.	32	0	18½	1	7	8	
Shaw, R. N.	Do.	5	0	28	0	3	5	
Totley School	Do.	4	0	0	0	3	2	
Ward, Joseph	Do.	6	2	27	0	5	2	
Waterfall, J. and H.	Do.	49	2	38	1	19	10	
		A.	371	2	4	£21	15	11



FIELD HEAD OR LOW FIELD HOUSE.
IN LOT XV, MAP No. 3.

Field Head or Low Field House



Day & Son Litho to the Queen.

FIELD HEAD OR LOW FIELD HOUSE .

IN LOT XV, MAP N^o 3 .

*Fowler Son
Sheffield*

TENANT'S NAME.	NO. ON PLAN.	DESCRIPTION.	QUANTITY.	TOTALS.
		Brought forward ...	A. R. P.	A. R. P.
		IN THE TOWNSHIP OF NETHER HALLAM.		32. 3. 14
		LOT 6.		
		Land Tax of 4d. per annum is payable upon No. 18 in this Lot.		
James Shipham ...	18	Farm-House, Barn, Stable, Shed, Piggeries, Outbuildings, and Garden ...	0 1 22	
John Boler ...		Cottage House, Shop, and Garden ...		
James Shipham ...	18a	Cowen Field ...	1 2 15	1. 3. 37
		IN THE TOWNSHIP OF NETHER HALLAM.		
		LOT 7.		
In hand ...	19	Plantation ...	0 0 30	
Fisher Godwin ...	20	Market Garden ...	2 0 22	
Surveyors of Highways of Nether Hallam ...	21	Footpath ...	0 0 21	
Fisher Godwin ...	22	Stack Yard ...	0 0 15	
Do. ...	23	House, Outbuildings, and Yard ...	0 1 9	
Do. ...	24	Market Garden ...	0 2 15	
Watch Committee of the Borough of Sheffield ...	25	Cottage and Garden ...	0 0 18	
Surveyors of Highways of Nether Hallam ...	26	Pinfold ...	0 0 1	
Fisher Godwin ...	27	Nursery Garden ...	5 1 29	
Do. ...	28	Croft ...	1 1 29	
Do. ...	29	Nursery Garden ...	1 2 30	
In hand ...	30	Wood ...	1 1 2	13. 1 21
		IN THE TOWNSHIP OF NETHER HALLAM.		
		LOT 8.		
In hand ...	31	Wood ...	0 1 12	
		IN THE TOWNSHIP OF ECCLESALL BIERLOW.		
William Ellis ...	32	Matwell Car ...	2 3 21	
Do. ...	33	Footpath ...	0 0 3	
William Ellis ...	34	Part of Little Matwell Car ...	0 2 9	
Do. ...	35	House, Tilt Yard, and Outbuildings, called Heeley Tilt ...	0 0 25	
Do. ...	36	Dam Goit ...	1 0 30	
Do. ...	37	Garden ...	0 1 6	
Do. ...	38	Strip of Land ...	0 1 0	
		IN THE TOWNSHIPS OF NETHER HALLAM AND ECCLESALL BIERLOW.		
Fisher Godwin ...	39	Nursery Garden ...	2 0 25	7. 3 11.
		IN THE TOWNSHIP OF NETHER HALLAM.		
		LOT 9.		
In hand ...	40	Plantation ...	0 0 13	
George Mounsey ...	41	Garden ...	0 0 10	
Isaac Kay ...	42	Garden ...	0 0 7	
Charles Gill ...	43	Garden ...	0 0 5	
William Wilson ...	44	Garden ...	0 0 9	
Mary and James Brailsford ...	45	Tail Goit ...	0 0 12	
Samuel Wilson ...	46	Garden ...	0 0 14	
William Harwick ...	47	Garden ...	0 0 12	
		Carried forward ...		56. 0. 3

TENANT'S NAME.	NO. ON PLAN.	DESCRIPTION.	QUANTITY.	TOTALS.
		Brought forward ...	A. R. P.	A. R. P.
		LOT 9.—CONTINUED.		56. 0. 3
Wilson ...	48	Garden ...	0 0 8	
Samuel Naylor ...	49	Garden ...	0 0 13	
Henry Bird ...	50	Garden ...	0 0 12	
Samuel Groves ...	51	Garden ...	0 0 11	
John Marsden ...	52	Garden ...	0 0 13	
James Laycock ...	53	Garden ...	0 0 13	
Samuel Wilson and Horatio Laycock ...	54	Two Houses and Gardens, Outbuildings, and Yard ...	0 0 25	
John Benney ...	55	House and Yard ...	0 0 3	
Mrs. Lydia Kinder ...	56	House and Garden ...	0 0 10	
Mary and James Brailsford ...	57	Corn Mill, called Heeley Low Mill ...	0 0 25	1. 1. 15
		IN THE TOWNSHIP OF ECCLESALL BIERLOW.		
		LOT 10.		
Abraham Howe ...	58	Mill Field and Plantation ...	4 2 26	
Do. ...	59	Part of Pond ...	0 0 24	
Do. ...	60	Part of Broad Field ...	3 2 22	
Do. ...	61	Messuage, House, Outbuildings, and Gardens ...	0 2 7	
Do. ...	62	Ditto ditto ditto ...	0 1 37	
Do. ...	63	Barn, Stable, Cowhouse, and Yard ...	0 1 7	
Do. ...	64	Carriage Road and Road to Mill Field ...	1 0 3	
Richard Solly ...	65	Part of Broadfield ...	0 1 32	11. 0. 38
		IN THE TOWNSHIP OF ECCLESALL BIERLOW.		
		LOT 11.		
Richard Solly ...	66	Part of Broad Field ...	5 2 29	
Abraham Howe ...	67	Part of Broad Field and Plantation ...	2 3 6	
Do. ...	68	Part of Pond ...	0 0 27	
Mrs. Hodgson ...	69	Lathe Field ...	4 3 38	
In hand ...	70	Plantation ...	0 2 10	
Trustees of Ower Bar Road ...	71	Toll House and Garden ...	0 0 18	
The Buttery Iron Company ...	72	South Croft ...	4 0 10	
Do. ...	73	Part of North Croft ...	2 1 23	
Do. ...	74	Stone Yard and Shed ...	0 0 5	
In hand ...	75	Plantation ...	0 0 34	
The Buttery Iron Company ...	76	Part of North Croft ...	0 3 29	
Do. ...	77	Part of North Croft ...	0 0 8	
In hand ...	78	Plantation ...	0 1 13	
Richard Solly ...	79	Garden ...	0 0 4	22. 1. 14
		IN THE TOWNSHIP OF ECCLESALL BIERLOW.		
		LOT 12.		
Mrs. Hodgson ...	72	The Leys and Part of Great Car ...	3 2 32	3. 2. 32
		IN THE TOWNSHIP OF ECCLESALL BIERLOW.		
		LOT 13.		
Abraham Howe and others ...	73	Part of Great Car ...	3 3 12	3. 3. 12
		Carried forward ...		98. 1. 34

TENANT'S NAME.	NO. ON PLAN.	DESCRIPTION.	QUANTITY.	TOTALS.
		Brought forward	A. R. P.	A. R. P. 98. 1.34
IN THE TOWNSHIP OF ECCLESALL BIERLOW.				
LOT 14.				
Alfred Holland and others	74	Part of Great Car	4 3 15	4. 3.15
IN THE TOWNSHIP OF ECCLESALL BIERLOW.				
LOT 15.				
Richard Solly	83	Orchard	0 1 20	
Do.	84	Part of Croft	0 2 5	
Do.	85	Message-House called Lowfield or Broadfield, Stables, Outbuildings, Yards, Garden, Vineries, and Carriage Road	0 2 33	
Do.	86	Part of Croft	1 0 20	2. 2.38
IN THE TOWNSHIP OF ECCLESALL BIERLOW.				
LOT 16.				
John Harrop	89	Lower Scargill Field and Plantation	2 2 25	
William Jones	90	Lower Long Field	1 3 35	
Do.	91	Middle Long Field	1 1 12	
	92	Part of Upper Long Field	0 1 5	
James Anthony	93	Middle Scargill Field and Plantation	2 0 16	
	94	Road	0 1 31	
Albert Smith	95	Land on Lease	0 3 11	
Nathaniel Creswick	96	Land on Lease	0 1 18	
Do.	97	Land on Lease (Plantation)	0 0 7	
Representatives of Rev. Jonathan Alderson	98	Land on Lease (Plantation)	0 0 13	
Do.	99	Land on Lease	0 1 18	
Do.	100	Land on Lease	0 3 26	
	101	Occupation Lane	0 0 22	11. 1.39
In this Lot No. 95 and half of the adjoining Road No. 94, so far as it runs alongside the same, are sold subject to a Lease thereof to Mr. John Harrop for 800 years from Lady-Day 1842, upon which a Rent is payable of £17. 16s. 6d. per Annum.				
No. 96 and half of the adjoining Road No. 94 so far as it runs alongside the same and No. 97, are sold subject to a Lease thereof to Mr. Nathaniel Creswick for 800 years from Lady-Day 1842, upon which a Rent is payable of £22. 17s. 11d. per Annum.				
Nos. 98 and 99 and half of the adjoining Road No. 94 on the Southern side thereof, so far as it runs alongside thereof, and No. 100 are sold subject to a Lease thereof to the Rev. Jonathan Alderson, for 800 years from Lady-Day 1842, upon which a Rent is payable of £85. 12s. 9d. per Annum.				
IN THE TOWNSHIP OF ECCLESALL BIERLOW.				
LOT 17.				
Fisher Godwin	87	Part of Lower and Upper Matwell Car	4 0 21	
Do.	88	Part of Lower Matwell Car	1 3 10	
William Ellis	34a	Part of Little Matwell Car	0 1 22	6. 1.13
TOTAL of SHEFFIELD ESTATE, Map No. 3				123. 3.19

MAP No. 1.

NORTON ESTATE, AS ALLOTTED FOR SALE.

1849.

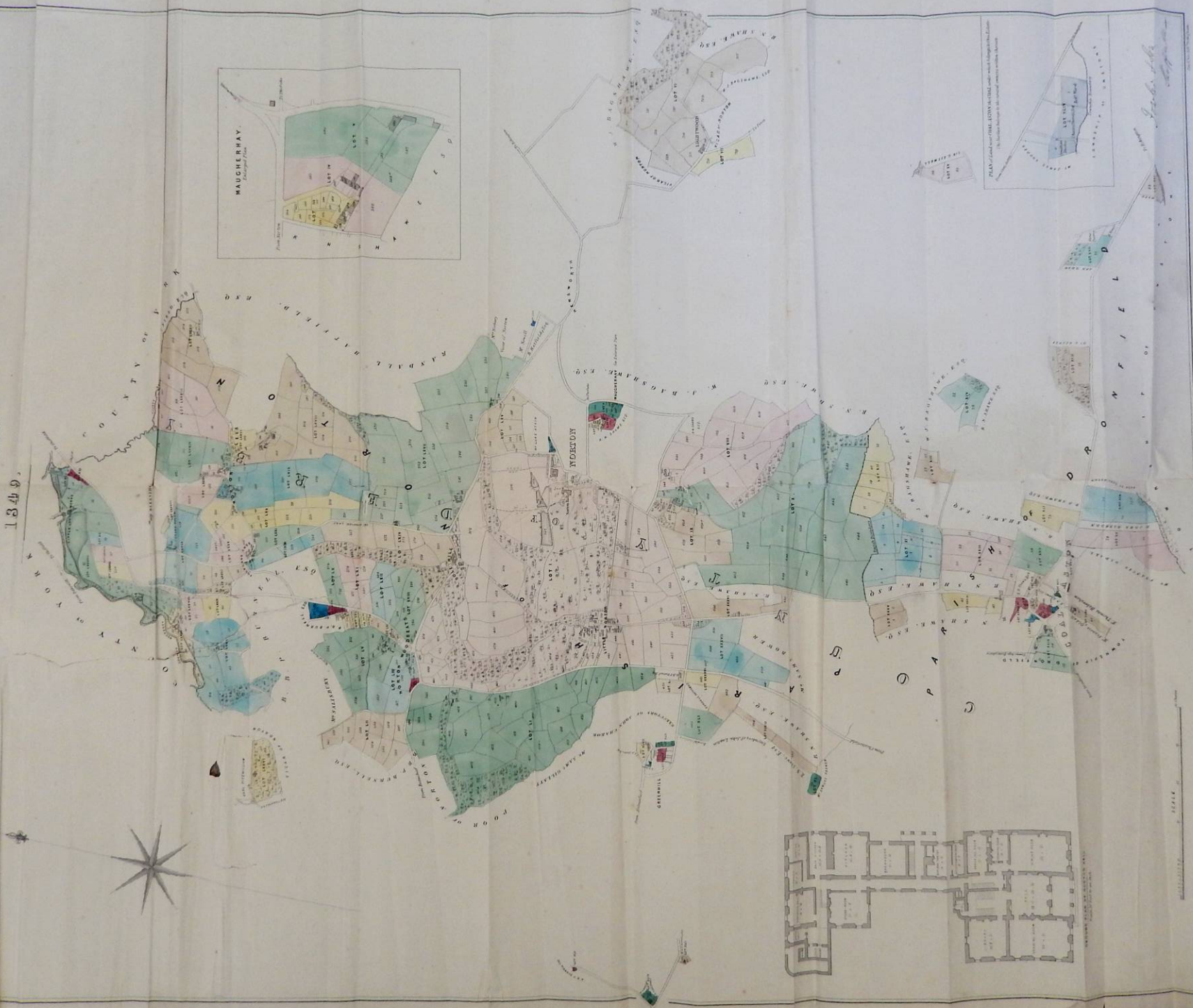

MAP - N^o 2.

AS ALLOTTED FOR SALE.

1849.

The Hon.
The Field.



For Mr. M. P. M. -

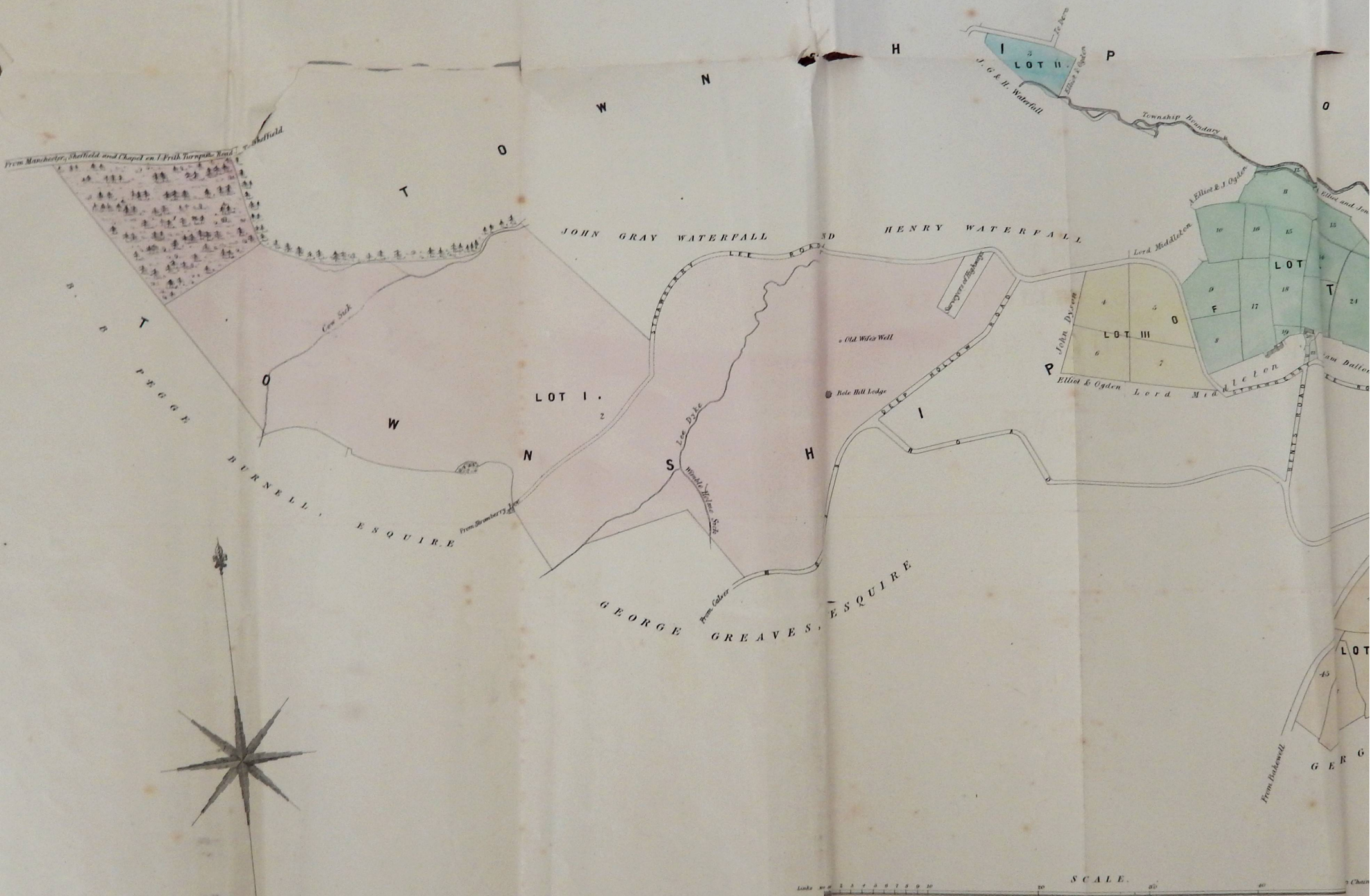

BROADFIELD AND HEELEY ESTATES,

AS ALLOTTED FOR SALE.

1849.

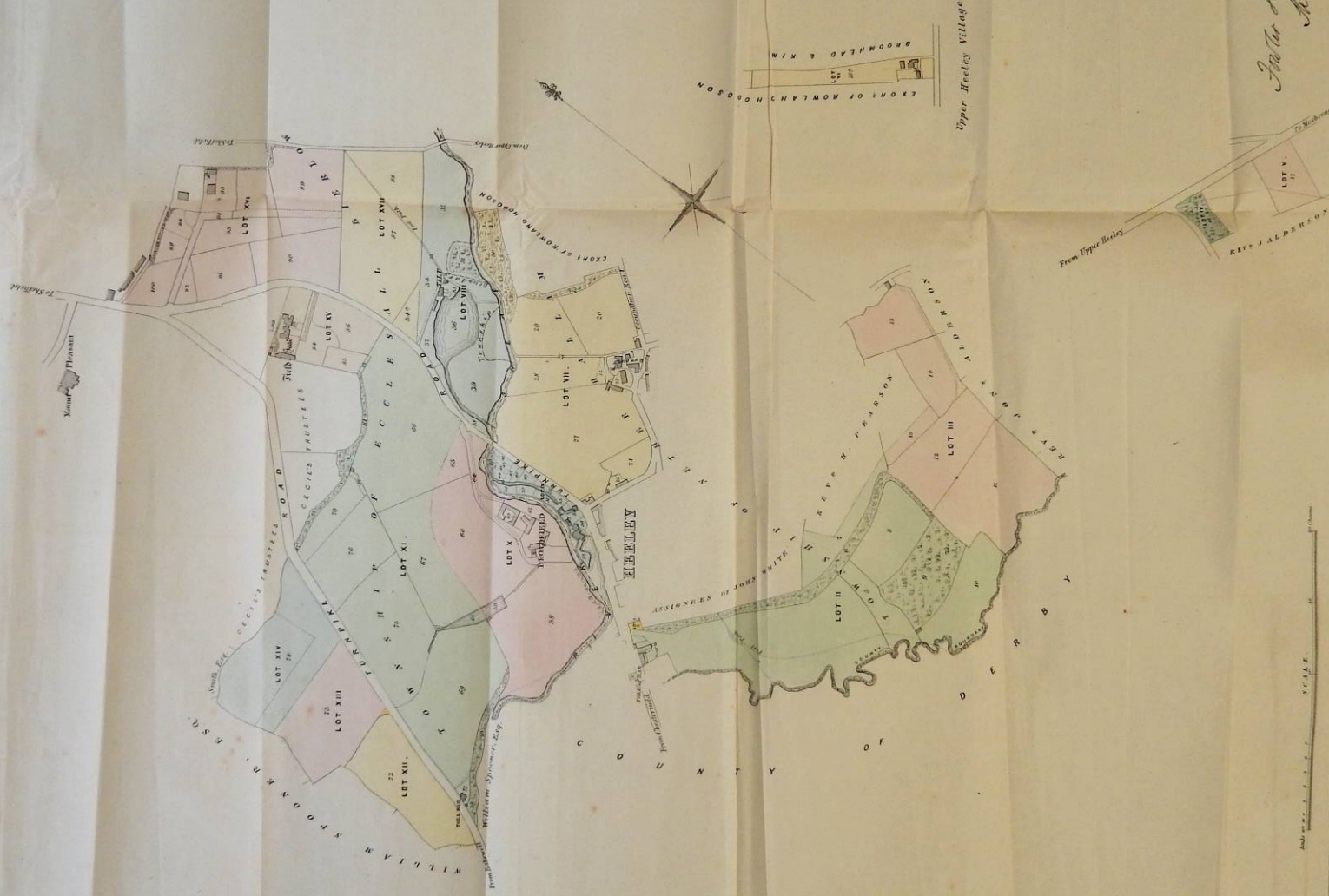

For two sets,
the price. —

II. The Auctioneer shall fix the advance to be made on each Bidding, and no person shall retract a Bidding; and if any dispute arise as to any Bidding, the Lot as to which such dispute shall arise shall be put up to Sale again at the last preceding Bidding.

IV. The Master's Report of the Purchase or Purchases, and the confirmation thereof, will be taken out and procured free of all expense to the Purchaser or Purchasers; but the Purchasers shall be at liberty to take out and procure the same at their own expense, if they shall think fit.

VI. In all cases where, from the changes of the names of closes, the removal of fences, or from any other circumstance whatever, the Vendors cannot identify any Lot, or portion of a Lot, with the descriptions contained in the respective documents of title, the abstract of title as to such Lot, or portion of a Lot, shall commence with an indenture of bargain and sale, dated the 27th Nov. 1757, and the recovery in pursuance thereof, if such Lot or portion of a Lot shall be in Derlyshire; or with the will of Samuel Shore, Esq., who died in the year 1785, if such Lot or portion of a Lot shall be in Yorkshire. And the Vendors shall, by statutory declarations of parties who have long known the Property, or by the production of old maps, or otherwise establish, that such Lot or portion of a Lot has been enjoyed for at least thirty years preceding the day of Sale consistently with the title thus deduced; and thereupon it shall be presumed that such Lot or portion of a Lot was comprised in and passed by the said Indenture, or by the general devise or bequest contained in the said will, as the case may be, although such Lot or portion of a Lot may be hereunder referred to as passing under any particular title, which is supposed to apply thereto.

[illegible]

having been made. No Purchaser shall make any objection or requisition for or in respect of any original grant of or any earlier title to the said tithes, or of any invalidity in the said conveyance of 1775, or of any liability to the repairs of the said chancel, nor shall any title whatever other than such declaration be required as to the tithes of the property above excepted. As to the tithes of the property in Yorkshire, and in the township of Dore, purchasers shall not require any title save such a statutory declaration by the said Mr. William Wright as is hereinbefore mentioned.

IX. The land tax of large portions of property has from time to time been redeemed; but the Vendors cannot undertake to identify any particular portion of the property with the property referred to in any certificate of the redemption of land tax. Purchasers shall therefore be satisfied with statutory declarations to be made by the said Mr. Wm Wright, that no land tax has been paid for the property comprised in their respective purchases, except as mentioned in the Particulars of Sale, since the commencement of the year 1838.

X. By a plain copy of the will of Samuel Shore, Esq., who died in 1785, it appears that the testator devised all his hereditaments to his son, Samuel Shore, Esq., then of Norton Hall, but afterwards of Meersbrook, absolutely charged with debts and legacies, and appointed him sole executor. The will appears to have been registered in the books of the Company of the Navigation of the River Don, in April 1801, and the said Samuel Shore, the son, was his father's heir-at-law. No objection shall be made in respect of this will not being produced, or shewn to have been proved.

XI. In all cases where land shall have been taken in exchange, before the year 1790, no objection or requisition shall be made in respect of the title to the lands given in exchange, or in respect of any right of re-entry in case of eviction therefrom.

XII. No objection shall be made on account of the non-production of the instrument creating any term of years which, in any document of title dated upwards of sixty years ago, is mentioned as having been created before the year 1740, or whereof the date of the commencement is not mentioned.

XIII. As to such portions of the NORTON and COAL ASTON ESTATES as were comprised in a mortgage to Messrs. Gell and Toplis in 1793, which mortgage was transferred by them in 1801:

No objection or requisition shall be made in respect of the fact, which appears by the mortgage deed, that the mortgage money was subject to the trusts of the settlement of a lady and gentleman who concurred in the mortgage and in the transfer of it.

XIV. As to the same Property:

Miss Anna Maria Griffith, who was entitled to the said mortgage, died in 1805 intestate, and administration was granted in February, 1806, by the Prerogative Court of York, to Elizabeth Sidney Griffith and Henrietta Griffith, as her only sisters and next of kin. Of these the former appointed the latter her executrix, who proved her will in 1813. The party claiming, according to the aforesaid title, was in the suit of Shore v. Shore, reported to be a creditor for the whole amount of the mortgage debt, and he was paid the whole of such amount with the approbation of the Master.

No objection or requisition shall be made in respect of the nonconcurrence in the reconveyance of any administrator, *de bonis non* of the said Anna Maria Griffith.

XV. As to such portions of the NORTON and COAL ASTON ESTATES, as were comprised in a mortgage to Mr. Isaac Wilkinson in 1798, or in a deposit of Deeds with him in 1799:

By a Deed of Transfer of Mortgage, dated in March, 1839, it is recited that the original Mortgagee, who died in 1816, (and whose personal representatives were parties to the transfer of mortgage) appointed three persons his residuary legatees and executors, and that of these three, one, (*viz.*, Esther Touchet,) died in 1818; and that she or her husband had received their share of the said residuary personally, and that the mortgage in question had been allotted as part of the shares of the other two residuary legatees.

The parties claiming under the said other two residuary legatees, were in the said suit of Shore v. Shore reported to be creditors for the whole amount of the mortgage debt, and were paid the same with the approbation of the master.

No objection or requisition shall be made by reason of no personal representative of the said Esther Touchet having been a party to the transfer of mortgage or to the reconveyance.

XVI. As to Nos. 664 and 665 in Lot 39 of the NORTON and COAL ASTON ESTATES:

Evidence will be given that the late Samuel Shore, Esq., and those claiming under his will, have been in the enjoyment of this property for the last thirty years; and the Purchaser shall, therefore, presume that it passed by such will, and shall not make any objection in respect of the said property, having been in 1815 under the Norton Inclosure Act awarded to any other person.

XVII. As to all Lot 1 and No. 2 in Lot 2, in YORKSHIRE:

The Vendors have in their possession the abstract of title used on occasion of the purchase of this property by the late Samuel Shore, Esq., in 1836, and a conveyance in 1804, by the Duke of Norfolk, under the Land Tax Redemption Acts, with which that abstract commences, but have none of the other documents of title mentioned in the said abstract, which, however therein appear to have been all registered at Wakefield, except a fine and two wills; in the conveyance to the said Samuel Shore, dated the 16th of February, 1836, is contained a covenant for the production of the principal deeds since 1804, mentioned in the said abstract. Evidence of enjoyment, according to the title, since the purchase by Mr. Shore, will be given, if required. No objection or requisition shall be made on account of the non-production or otherwise, in respect of the title anterior to 1836. The conveyance of 1804, however, will be produced to the Purchaser.

XVIII. As to a small portion of Lots 7 and 8 in YORKSHIRE, or one of them:

By deed dated 5th Queen Anne, now in the Vendors' possession, this portion was vested in trustees for the residue of a term of 800 years; and (after failure of issue of a person therein named,) a trust was declared for Mr. Samuel Shore (who died in 1750) absolutely. It appears that the said Mr. Shore paid off certain charges on the property, and the freehold reversion was conveyed to his grandson, Samuel Shore, Esq. in 1810; and the before mentioned evidence of enjoyment, according to the title for 30 years will be given. No objection or requisition shall be made on account of the trust, declared by the said deed of 5th Queen Anne having been legally invalid, or of any legal estate in the said term, being outstanding under the said deed.

XIX. As to a small portion of Lots 7 and 8 in YORKSHIRE, or one of them which was formerly copyhold:

No objection shall be taken on account of Samuel Shore, Esq., of Meersbrook, to whom this property was conveyed, by way of enfranchisement, by deed dated 1785, under the Sheffield Market Act, not having been previously admitted tenant on the rolls.

XX. The respective titles to the undermentioned portions of the property in NORTON and COAL ASTON, so far as the same can be identified with the descriptions in the documents of title, shall commence with the undermentioned deeds and documents of title; and notwithstanding any recital or statement of any fact or document, or any covenant to produce any earlier document, no Purchaser shall call for or make any objection or requisition in respect of any earlier title, (that is to say):

As to the RECTORY OF NORTON; as to Nos. 472 to 476 both inclusively, except a small piece of 475 which is inclosure; as to the LYER LANDS WOOD in No. 477 in Lot 1; Nos. 390, 392, 393, 394, 400 to 403 both inclusively, and the North of 404 in Lot 51; No. 273 (except inclosure on the South) in Lot 64; Lot 72; No. 66 in Lot 73; Lot 76; No. 63a in Lot 78; No. 72a in Lot 79; and No. 22 in Lot 87:

2nd and 3rd July 1798, a conveyance in fee by Sir George Arnytage and others, to Samuel Shore, Esq., of Meersbrook. N.B.—No objection or requisition shall be made in respect of a sum of £1000 charged on the property in 1771, and in 1798 recited to have been paid, or secured to the satisfaction of the said Samuel Shore.

As to No. 470 in Lot 1; Nos. 374, 374a, 375, in Lot 53; No. 305 in Lot 56; and Nos. 306 to 321, both inclusively, in Lot 57:

27th and 28th of Sept. 1805, a conveyance in fee to Samuel Shore, Esq., of Meersbrook. N.B.—The Vendor shall not be required to give evidence that one Rachel Tappenden, the wife of the grantor, died without any child living at her death. It appears by previous documents that she was married previously to Sept. 1793, and she is mentioned in a bond of indemnity, bearing even date with the conveyance of 1805, to have then had no children.

As to the Chancel of Norton Church, or the part thereof sold:

16th May 1814, grant in fee to S. Shore, Esq., of Meersbrook.

As to Nos. 16 and 18 in Lot 12; and No. 2 in Lot 35:

24th and 25th June 1793, a conveyance in fee.

As to part of No. 20 in Lot 12; and as to No. 1 in Lot 35:

12th and 13th Sept. 1828, a conveyance in fee by Robert Newton Shawe, Esq. to the late S. Shore, by way of exchange. N.B.—No objection or requisition shall be made for or in respect of the title of the lands given in exchange, or of any right of re-entry in case of eviction therefrom.

As to No. 33a in Lot 23, and the tithes thereof; and as to Lot 25:

10th and 11th Dec. 1824, a conveyance in fee to Samuel Shore, Esq., of Meersbrook.

As to the reversion in fee-simple subject to a term of 800 years in No. 36 in Lot 24, (except a small portion on the south-west side, which was inclosure), in Nos. 38 and 39 in the same Lot, and in Lot 26:

16th March 1833, an assignment of the said term to the late Samuel Shore, Esq., to merge in the inheritance therein recited to be vested in the said Samuel Shore, as heir and devisee of his father.

As to Nos. 673d, 673e, 673f, and 673g in Lot 44, except a small portion which was inclosure:

25th and 26th of Feb. 1830, a conveyance in fee to the late Samuel Shore, Esq.

As to Nos. 425 to 429, both inclusively, in Lot 47 (except a portion which was allotment); and as to Lot 48:

Will of Thomas Biggin, proved in 1805, and which shall be presumed to have comprised the said property. N.B.—The title from Mr. Biggin's devise to the conveyance in fee to the late S. Shore, Esq., in Feb. 1836, will be taken from an old abstract, apparently used on the occasion of Mr. Shore's purchase; and there is a covenant to produce the most important of the previous deeds mentioned in the abstract. No objection or requisition shall be made in respect of the non-production or otherwise in respect of any title earlier than the deed of 1836, or of the non-verification of the contents thereof, or of the other matters aforesaid.

As to No. 372 in Lot 53:

3rd of Feb. 1823, an indenture of assignment, wherein it is recited that the assignor was possessed of or otherwise well entitled to the property for the remainder of a term of 800 years.

As to the reversion in fee simple to a term of 500 years in No. 263, Lot 64:

27th of May 1835.

As to a small part on the East of No. 133 in Lot 69; Nos. 102 and 103 in Lot 82; Nos. 101, 110, and 111, in Lot 83; and No. 118 in Lot 85:

24th and 25th March 1801, a conveyance in fee to Samuel Shore, Esq., of Meersbrook. N.B.—No objection or requisition shall be made in respect of four reversionary legacies of £400 each, charged on the property, but as to which it is recited that the legatees presumptively entitled (who were parties and released) were satisfied that the remaining Estates charged with the legacies were an ample security for the same. One of the legatees was a married woman, and joined with her husband in releasing.

As to Nos. 46 and 47 in Lot 75:

2nd and 3rd of July, 1798, a conveyance in fee to Thomas Drake.

As to the chief-rent of £9. 7s. 10d., formerly issuing out of the Rectory of Norton, and certain undefined portions of the late Mr. Shore's Estate at Bradway, Greenhill, and Woodseats,

18th and 19th March 1830, a conveyance in fee of the said rent to the late S. Shore, Esq.

XXI. The respective titles to the undermentioned portions of the property in Yorkshire, so far as the same can be identified with the descriptions in the documents of title, shall commence with the undermentioned deeds and documents of title: and notwithstanding any recital or statement of any fact or document, or any covenant to produce any earlier document, no Purchaser shall call for or make any objection or requisition in respect of any earlier title; that is to say—

As to Nos. 25 and 26, and parts of Nos. 24 and 27, in Lot 7:

22nd and 23rd Feb. 1804, a conveyance in fee by the trustees for sale of parts of the settled estates of Charles Duke of Norfolk to Samuel Shore, Esq., of Meersbrook.

As to the inheritance of a small portion of Lots 7 and 8, or one of them; and of a small part on the south of Lot 16, and as to the inheritance of Lot 17:

16th March, 1810, a grant of the reversion in fee to the said Samuel Shore.

As to that part of No. 7 in Lot 2 not allotted to Samuel Shore, Esq.; and as to Lot 3:

11th and 12th Oct. 1810, a conveyance in fee to the said Samuel Shore

As to a term of 800 years in Lot 17, and a small portion at the south of Lot 16 (of which premises the inheritance was conveyed to Samuel Shore, Esq., of Meersbrook, in 1810.)

10th Feb. 1753, an unstamped receipt whereby Wm. Stanforth acknowledged the receipt of a sum of money from Mr. Shore, and promised for himself and all concerned to execute such writings as to make a sufficient title, but which he does not appear to have ever done.

XXII. The abstract of title to any Lot or Lots, the aggregate purchase monies of which shall not exceed £300, shall (except where otherwise provided for by these Conditions,) commence with the first deed, will, or other document relating to each portion of the property comprised in the purchase, which shall bear date subsequently to the 2nd day of July, 1830, and the Purchaser or Purchasers shall not require or make any requisition or objection in respect of any previous title, notwithstanding any recital or notice of any previous document, fact, or matter; but any Purchaser wishing to have the usual title under the other Conditions herein contained may have the same at his own expense.

XXIII. All certificates, declarations, and official, attested, or other copies of any wills, letters of administration, proceedings in Chancery, or other documents not in the possession of the devisee in trust for sale, which shall be required by any Purchaser, subject to the stipulations contained in these Conditions, whether for verifying any abstract or any recital therein, or for any other purpose whatever, and all statutory declarations and other evidence by these Conditions agreed to be furnished, shall be obtained at the expense of the respective Purchasers requiring the same. In case of the death of the aforesaid Mr. Wm. Wright, without making the statutory declarations hereby agreed to be furnished, such declaration shall be made by some other competent person.

XXIV. The expenses of the Purchaser attending the comparison and examination of any of the abstracts with the deeds and evidences of title, wherever or in whose custody soever the same may be, and of ascertaining the courts and places where wills, documents, and registries are to be found, and comparing the abstract therewith, and all the expenses of journeys undertaken by or on behalf of any of the parties to the suit for any of the purposes aforesaid, shall be exclusively borne by the Purchaser requiring the same; and no Purchaser shall require the original deeds and evidences of title, or extracts or copies of any deeds, wills, or other documents relating to the title, to be produced for examination at his dwelling-house or office, or that of his counsel or solicitors, but the same shall be examined at the usual place of deposit thereof.

XXV. The quantities stated in the foregoing printed Particulars of Sale shall be taken to be correct, and no allowance shall be made on either side if it should afterwards appear that the said quantities, or any of them are incorrectly stated.

XXVI. If it should appear that a good title cannot be made to any part of any Lot, not important to the enjoyment of the residue of such Lot, the contract for sale shall nevertheless be carried into effect as to the residue of such Lot, and a proportionate reduction made in the purchase money; and such reduction, and the question whether the part to which a good title is not made is important to the enjoyment of the residue of any Lot, shall be determined by the said Master; and the expense of every such reference shall be in the discretion of the said Master.

XXVII. Each Purchaser shall, upon payment of his purchase money, in manner hereinafter mentioned, have a proper conveyance of the Lot or Lots purchased by him from the Devisee in Trust for sale, in whom all the Estates are now vested, and from all other necessary parties, if any; and such conveyance shall be prepared by the Purchaser, and the draft thereof shall be left at the Offices of Messrs. ALBERT SMITH and SOX aforesaid, for perusal on behalf of such Devisee, (such Draft to be settled by the Master in case the parties shall differ, but not otherwise.) And the Purchaser shall not require any covenants for title other than the usual trustees' covenant, by the Devisee in Trust for sale.

XXVIII. The Purchasers shall be at the expense, in all respects, of their respective conveyances, and of getting the same perused on behalf of and executed by all parties (if any) whom they may consider necessary, except the said Devisee in trust for sale, and also at the expense of the acknowledgment of any deeds by married women (if any,) and of tracing, constituting, or evidencing, the personal representation to any deceased trustees of satisfied terms, expressly or constructively attendant on the inheritance, whose concurrence they may consider expedient, and of getting in the same terms, or any other outstanding terms; and shall not be entitled to any allowance for extra length of such conveyance on any account whatsoever.

XXIX. The Purchasers shall, on or before the 20th day of Dec. 1850, pay the amount of their respective purchase monies into the Bank of England, with the privy of the Accountant-General of the Court of Chancery, to the credit of the cause *Shore v. Shore*, to an account to be entitled "The money arising from the sale of the real estate of the testator Samuel Shore," and on payment of such purchase monies such Purchasers shall be entitled to the possession of such part or parts of the said Lot or Lots so purchased by them respectively, as shall be then unlet, and shall also be entitled to the rents of such part or parts of the said Lot or Lots so purchased by them respectively as shall be then let as from the then last preceding day on which such rent is due and payable, and the said Purchasers shall, on the said 20th day of December day up to the said 20th day of December, 1850. And up to that time all outgoing shall be cleared by the Vendors free of all expense to the Purchaser. And if by reason of any farm or holding being comprised in two or more Lots, the proportion of the rent to be paid by such Purchaser as aforesaid shall be undefined, it shall be determined by the said Mr. Wm. Wright, the receiver, whose determination shall be conclusive.

XXX. If from any cause whatsoever, except the wilful neglect or default of the Vendors, the Purchaser shall make default in payment of his purchase money in manner before mentioned, he shall pay interest after the rate of £5 per centum upon the amount of the purchase money from the said 20th day of December, 1850 until the payment thereof.

XXXI. Each Purchaser shall, on completion of the purchase, be entitled to such of the title deeds and documents in the custody or power of the said Devisee in trust for sale as relate solely to property purchased by him; but such of the said deeds and documents as relate to property comprised in more than one purchase shall, if all the Lots under the same title be sold at this Sale, be delivered to and retained by the Purchaser of the largest value under the same title, who shall enter into the usual covenants with the Purchasers of the other Lots, at their expense, for the production of such deeds and documents, and for furnishing copies, extracts, or abstracts thereof; but the deeds and documents relating to Lots sold at this Sale, and also any other Lot or Lots remaining unsold, or to other property not comprised in this Sale, shall remain in the custody of the person or persons who now hold the same, with liberty to the Purchasers of the Lots sold at this Sale to which the same relate, to inspect such deeds and documents from time to time, at their own expense, but without any right to require any covenant or undertaking for the production thereof; and when all the Lots or other Property to which such deeds or documents relate shall have been sold, the deeds and documents which may have been so retained shall be delivered up to the largest Purchaser in value under that title, and he shall, if required, enter into covenants with the Purchasers of the Lots sold at this Sale under the same title, at their respective expense, for the production of such deeds and documents, and for furnishing copies, extracts, and abstracts thereof in the usual manner.

XXXII. If any mistake shall be made, or any error shall appear, in the description of any Lots to which no other provision in these Conditions shall apply, such mistake or error shall not annul the Sale; but a compensation or equivalent shall be given or taken, as the case may require, such compensation or equivalent to be fixed by the said Master; but no allowance shall be made on either side for or in respect of any deficiency or excess of land.

XXXIII. That if any objection shall be made to the title to any or either of the foregoing Lots, the Vendors (notwithstanding any negotiation or any attempt to remove such objection,) shall be at liberty, with the approbation of the Master, to annul the sale thereof to any Purchaser; and in case they shall annul such sale, the Purchaser shall not be entitled to be paid any of the expenses of investigating the title, or any compensation in respect thereof.

Note.—THIS BEING A SALE BY DIRECTION OF THE COURT OF CHANCERY NO DEPOSIT WILL BE REQUIRED.